

AS- / ASU SERIES

ALUMINIUM ELECTROLYTIC CAPACITORS LONG LIFE GRADE

Series	Capacitance range	Voltage range	Temperature range	Case Φ x H	Applications
AS ASU	100-330000	25-500	-40 °C , +85°C	35 x 59 76 x 217	Long life High reliability Telecom, Railways applications

MECHANICAL OUTLINES:

CASE: aluminium made

TERMINALS:screw 5MA

SEALING: hermetic by beading on an EPR gasket, housed on a resin cover

PRESSURE RELEASE VENT: made in silicone-rubber

SLEEVE: self-extinguishing thermoshrinkable sleeve

SIZE: see enclosed drawings

MOUNTING HARDWARE: see hardware section

SPECIFICATIONS	TEMPERATURE RANGE	CAPACITANCE
CECC 30300 IEC 384-4 ("long life grade") MIL C62D DIN 41240 / DIN 45910	Operating: -40 °C/ +85 °C Climatic Category : 40/85/56	Tolerance shall be within the following limits: -10% +30% (standard tolerance) or -20% + 20% (available on request)

LEAKAGE CURRENT:

After the rated voltage has been applied to the capacitor for 5 minutes the leakage current must be:

Maximum limit	at 25 °C	$I_f \leq 1.5 * \sqrt{C*V}$
Operating limit	at 25 °C:	$I_f \leq 1.0 * \sqrt{C*V}$

where I_f = leakage current (μ A)

C = capacitance (μ F)

V = rated voltage (V)

IMPORTANT

1) When using high-capacitance and high-voltage electrolytic capacitors it is important to remember that the inner part (the rolled section) is not insulated from can: between the negative pole and the aluminium can there is a variable and not defined resistance essentially due to the electrolyte used in capacitor manufacture.

SURGE VOLTAGE

Working Voltage	25	40	63	100	160	200	250	350	400	450	500
Surge Voltage	40	55	84	130	215	250	300	425	475	525	550

RIPPLE CURRENT:

the allowable values of ripple current in amperes, are related to temperature and frequency by the formula:

$$I_r = K_t * K_f * I_{r85}$$

where I_{r85} is the limit given by tables, referred to a temperature of 85 °C and to a frequency of 100 Hz and K_t or K_f are values here below tabulated:

°C	40	55	65	75	85
K_t	2.1	1.8	1.6	1.3	1.0

V_n Hz	Kf					
	V=50			50<V=300		
	Code Diameter A,B			Code Diameter C,D		
50	0.82	0.79	0.76	0.86	0.78	0.72
100	1	1	1	1	1	1
120	1.03	1.04	1.04	1.01	1.02	1.03
200	1.08	1.12	1.17	1.03	1.06	1.14
300	1.12	1.16	1.28	1.03	1.08	1.24
400	1.13	1.20	1.35	1.03	1.09	1.29
500	1.15	1.22	1.39	1.03	1.09	1.32
>1000	1.18	1.25	1.45	1.03	1.09	1.37

DIMENSIONS

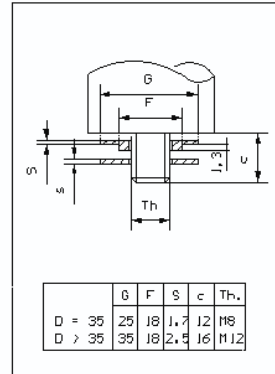
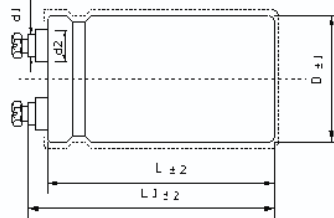
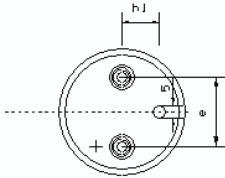

Insert Screw Thread = M5	Insert Screw Length (Terminal Code "-X") = 10 mm.
Insert Screw Torque Max. (M5) = 2 Nm.	Screw Torque For Hex Nuts M8 = 4 Nm.
Screw Torque For Hex Nuts M12 = 10 Nm.	

CASE CODE	Φ X L (mm)	l1	d1 ±, -0.5	d2 ±, -0.5	h1	e	CASE CODE	Φ X L (mm)	l1	d1 ±, -0.5	d2 ±, -0.5	h1	e
AA	35 x 59	57	8	12	8	12,7	DF	76 x 147	151	13	18	19	31.8
AB	35 X 79	86	8	12	8	12,7	DK	76 x 168	173	13	18	19	31.8
AC	35 X 105	109	8	12	8	12,7	DJ	76 x 217	222	13	18	19	31.8
BB	51 x 83	86	13	18	13	22.2	EC	90 x 108	112	17	23	19	31.8
BC	51 x 105	108	13	18	13	22.2	EF	90 x 149	153	17	23	19	31.8
CC	63 x 107	111	13	18	16	28.6	EJ	90 x 222	227	17	23	19	31.8
DC	76 x 107	111	13	18	19	31.8							

- STANDARD MOUNTING STUD HARDWARE - INSULATING PLASTIC WASHERS AND METALLIC NUT

EXPECTED LIFE AS A FUNCTION OF TEMPERATURE AND RIPPLE CURRENT

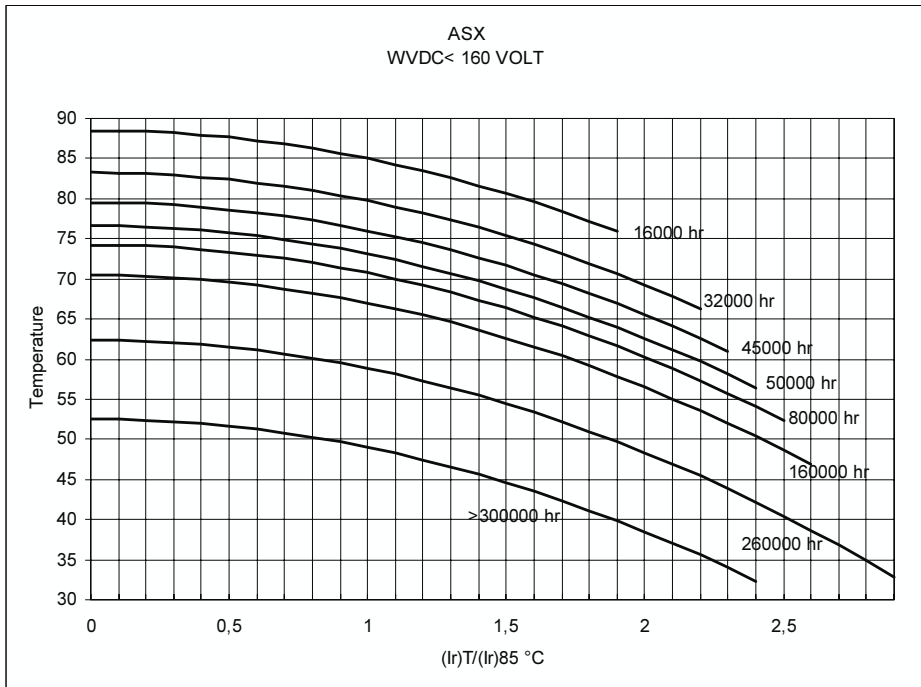

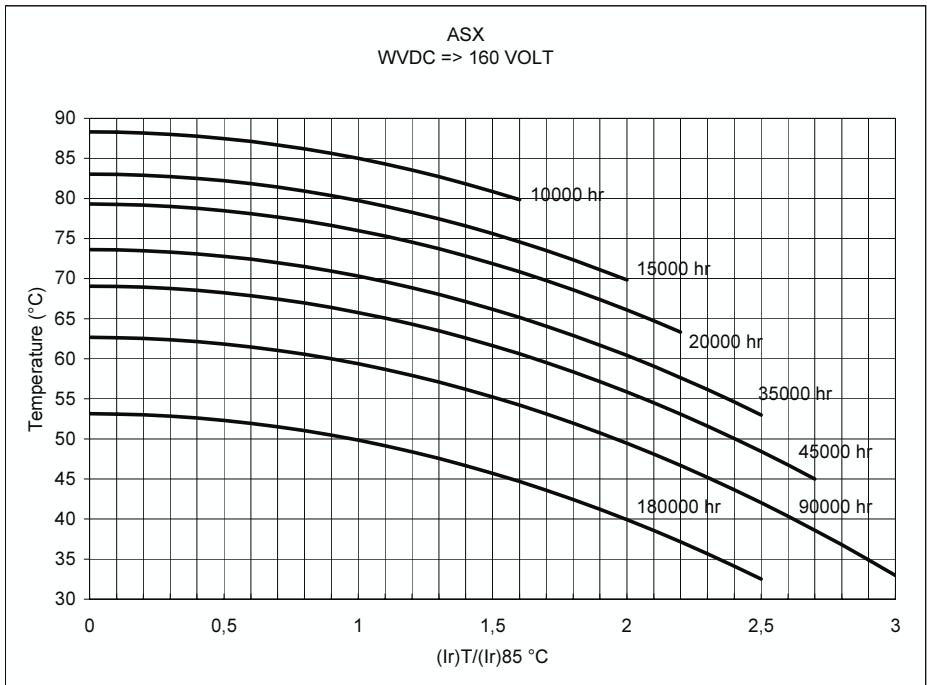

Expected life criteria : see introduction

CAP (μ F)	Rated Voltage (Vn)	Case Code	Φ x h (mm)	TG δ 100Hz	ESR	ESR	Z	I ripple	I ripple	CATALOGUE NUMBER	
					max 100Hz (mOhm)	typ. 100Hz (mOhm)	max 10KHz (mOhm)	55°C 100Hz (A)	85°C 100Hz (A)	Flat bottom	Mounting stud
6800	25	AA	35 x 59	0,22	52	41	38	9,0	4,9	ASM682X025AA1	ASUM682X025AA1
10000		AB	35 x 79	0,22	35	28	26	13,0	7,3	ASM103X025AB1	ASUM103X025AB1
15000		AC	35 x 105	0,22	23	19	17	18,0	10,2	ASM153X025AC1	ASUM153X025AC1
22000		BB	51 x 83	0,32	23	19	18	20,0	11,1	ASM223X025BB1	ASUM223X025BB1
33000		BC	51 x 105	0,36	17	14	14	26,0	14,5	ASM333X025BC1	ASUM333X025BC1
47000		CC	63 x 107	0,33	11	9	10	37,0	20,4	ASM473X025CC1	ASUM473X025CC1
68000		CC	63 x 107	0,39	9	7	8	41,0	22,6	ASM683X025CC1	ASUM683X025CC1
100000		DC	76 x 107	0,56	9	7	8	46,0	25,4	ASM104X025DC1	ASUM104X025DC1
150000		DF	76 x 147	0,75	8	6	8	55,0	30,8	ASM154X025DF1	ASUM154X025DF1

CAP (μ F)	Rated Voltage (Vn)	Case Code	Φ x h (mm)	TG δ 100Hz	ESR	ESR	Z	I ripple	I ripple	CATALOGUE NUMBER	
					max 100Hz (mOhm)	typ. 100Hz (mOhm)	max 10KHz (mOhm)	55°C 100Hz (A)	85°C 100Hz (A)	Flat bottom	Mounting stud
4700	40	AA	35 x 59	0,18	61	49	44	8,0	4,5	ASM472X040AA1	ASUM472X040AA1
6800		AB	35 x 79	0,21	49	39	35	11,0	6,2	ASM682X040AB1	ASUM682X040AB1
10000		AC	35 x 105	0,25	40	32	29	14,0	7,8	ASM103X040AC1	ASUM103X040AC1
15000		BB	51 x 83	0,27	29	23	21	18,0	10,0	ASM153X040BB1	ASUM153X040BB1
22000		BC	51 x 105	0,33	24	19	16	22,0	12,4	ASM223X040BC1	ASUM223X040BC1
33000		CC	63 x 107	0,35	17	14	12	30,0	16,6	ASM333X040CC1	ASUM333X040CC1
47000		CC	63 x 107	0,37	13	10	10	35,0	19,3	ASM473X040CC1	ASUM473X040CC1
68000		DC	76 x 107	0,42	10	8	8	44,0	24,2	ASM683X040DC1	ASUM683X040DC1
100000		DF	76 x 147	0,49	8	6	7	56,0	31,1	ASM104X040DF1	ASUM104X040DF1

CAP (μ F)	Rated Voltage (Vn)	Case Code	Φ x h (mm)	TG δ 100Hz	ESR	ESR	Z	I ripple	I ripple	CATALOGUE NUMBER	
					max 100Hz (mOhm)	typ. 100Hz (mOhm)	max 10KHz (mOhm)	55°C 100Hz (A)	85°C 100Hz (A)	Flat bottom	Mounting stud
3300	63	AA	35 x 59	0,12	58	46	40	8,0	4,7	ASM332X063AA1	ASUM332X063AA1
4700		AB	35 x 79	0,12	41	33	29	12,0	6,8	ASM472X063AB1	ASUM472X063AB1
6800		AC	35 x 105	0,12	28	22	20	17,0	9,3	ASM682X063AC1	ASUM682X063AC1
10000		BB	51 x 83	0,16	25	20	19	19,0	10,6	ASM103X063BB1	ASUM103X063BB1
15000		BC	51 x 105	0,16	17	14	14	26,0	14,7	ASM153X063BC1	ASUM153X063BC1
22000		CC	63 x 107	0,12	9	7	8	42,0	23,2	ASM223X063CC1	ASUM223X063CC1
33000		DC	76 x 107	0,16	8	6	8	49,0	27,3	ASM333X063DC1	ASUM333X063DC1
33000		DD	76 x 118	0,16	8	6	8	52,0	28,9	ASM333X063DD1	ASUM333X063DD1
47000		DC	76 x 107	0,18	6	5	6	55,0	30,8	ASM473X063DC1	ASUM473X063DC1
68000	DF	76 x 147	0,32	7	6	7	57,0	31,7	ASM683X063DF1	ASUM683X063DF1	

CAP (μ F)	Rated Voltage (Vn)	Case Code	Φ x h (mm)	TG δ 100Hz	ESR	ESR	Z	I ripple	I ripple	CATALOGUE NUMBER	
					max 100Hz (mOhm)	typ. 100Hz (mOhm)	max 10KHz (mOhm)	55°C 100Hz (A)	85°C 100Hz (A)	Flat bottom	Mounting stud
6800	25	AA	35 x 59	0,22	52	41	38	9,0	4,9	ASM682X025AA1	ASUM682X025AA1
10000		AB	35 x 79	0,22	35	28	26	13,0	7,3	ASM103X025AB1	ASUM103X025AB1
15000		AC	35 x 105	0,22	23	19	17	18,0	10,2	ASM153X025AC1	ASUM153X025AC1
22000		BB	51 x 83	0,32	23	19	18	20,0	11,1	ASM223X025BB1	ASUM223X025BB1
33000		BC	51 x 105	0,36	17	14	14	26,0	14,5	ASM333X025BC1	ASUM333X025BC1
47000		CC	63 x 107	0,33	11	9	10	37,0	20,4	ASM473X025CC1	ASUM473X025CC1
68000		CC	63 x 107	0,39	9	7	8	41,0	22,6	ASM683X025CC1	ASUM683X025CC1
100000		DC	76 x 107	0,56	9	7	8	46,0	25,4	ASM104X025DC1	ASUM104X025DC1
150000		DF	76 x 147	0,75	8	6	8	55,0	30,8	ASM154X025DF1	ASUM154X025DF1

CAP (μ F)	Rated Voltage (Vn)	Case Code	Φ x h (mm)	TG δ 100Hz	ESR	ESR	Z	I ripple	I ripple	CATALOGUE NUMBER	
					max 100Hz (mOhm)	typ. 100Hz (mOhm)	max 10KHz (mOhm)	55°C 100Hz (A)	85°C 100Hz (A)	Flat bottom	Mounting stud
4700	40	AA	35 x 59	0,18	61	49	44	8,0	4,5	ASM472X040AA1	ASUM472X040AA1
6800		AB	35 x 79	0,21	49	39	35	11,0	6,2	ASM682X040AB1	ASUM682X040AB1
10000		AC	35 x 105	0,25	40	32	29	14,0	7,8	ASM103X040AC1	ASUM103X040AC1
15000		BB	51 x 83	0,27	29	23	21	18,0	10,0	ASM153X040BB1	ASUM153X040BB1
22000		BC	51 x 105	0,33	24	19	16	22,0	12,4	ASM223X040BC1	ASUM223X040BC1
33000		CC	63 x 107	0,35	17	14	12	30,0	16,6	ASM333X040CC1	ASUM333X040CC1
47000		CC	63 x 107	0,37	13	10	10	35,0	19,3	ASM473X040CC1	ASUM473X040CC1
68000		DC	76 x 107	0,42	10	8	8	44,0	24,2	ASM683X040DC1	ASUM683X040DC1
100000		DF	76 x 147	0,49	8	6	7	56,0	31,1	ASM104X040DF1	ASUM104X040DF1

CAP (μ F)	Rated Voltage (Vn)	Case Code	Φ x h (mm)	TG δ 100Hz	ESR	ESR	Z	I ripple	I ripple	CATALOGUE NUMBER	
					max 100Hz (mOhm)	typ. 100Hz (mOhm)	max 10KHz (mOhm)	55°C 100Hz (A)	85°C 100Hz (A)	Flat bottom	Mounting stud
3300	63	AA	35 x 59	0,12	58	46	40	8,0	4,7	ASM332X063AA1	ASUM332X063AA1
4700		AB	35 x 79	0,12	41	33	29	12,0	6,8	ASM472X063AB1	ASUM472X063AB1
6800		AC	35 x 105	0,12	28	22	20	17,0	9,3	ASM682X063AC1	ASUM682X063AC1
10000		BB	51 x 83	0,16	25	20	19	19,0	10,6	ASM103X063BB1	ASUM103X063BB1
15000		BC	51 x 105	0,16	17	14	14	26,0	14,7	ASM153X063BC1	ASUM153X063BC1
22000		CC	63 x 107	0,12	9	7	8	42,0	23,2	ASM223X063CC1	ASUM223X063CC1
33000		DC	76 x 107	0,16	8	6	8	49,0	27,3	ASM333X063DC1	ASUM333X063DC1
33000		DD	76 x 118	0,16	8	6	8	52,0	28,9	ASM333X063DD1	ASUM333X063DD1
47000		DC	76 x 107	0,18	6	5	6	55,0	30,8	ASM473X063DC1	ASUM473X063DC1
68000		DF	76 x 147	0,32	7	6	7	57,0	31,7	ASM683X063DF1	ASUM683X063DF1

CAP (μ F)	Rated Voltage (Vn)	Case Code	Φ x h (mm)	TG δ 100Hz	ESR max 100Hz (mOhm)	ESR typ. 100Hz (mOhm)	Z max 10Khz (mOhm)	I ripple 55°C 100Hz (A)	I ripple 85°C 100Hz (A)	CATALOGUE NUMBER	
										Flat bottom	Mounting stud
680	100	AA	35 x 59	0,10	234	187	150	4,0	2,3	ASM681X100AA1	ASUM681X100AA1
1000		AB	35 x 79	0,10	159	127	105	6,0	3,4	ASM102X100AB1	ASUM102X100AB1
1500		AB	35 x 79	0,10	106	85	71	8,0	4,2	ASM152X100AB1	ASUM152X100AB1
2200		AC	35 x 105	0,10	72	58	49	10,0	5,8	ASM222X100AC1	ASUM222X100AC1
3300		BB	51 x 83	0,12	58	46	41	13,0	7,0	ASM332X100BB1	ASUM332X100BB1
4700		BC	51 x 105	0,12	41	33	29	17,0	9,5	ASM472X100BC1	ASUM472X100BC1
6800		BC	51 x 105	0,12	28	22	21	21,0	11,4	ASM682X100BC1	ASUM682X100BC1
10000		CC	63 x 107	0,12	19	15	14	28,0	15,6	ASM103X100CC1	ASUM103X100CC1
15000		DC	76 x 107	0,13	14	11	11	37,0	20,4	ASM153X100DC1	ASUM153X100DC1
22000		DF	76 x 147	0,13	9	8	9	51,0	28,3	ASM223X100DF1	ASUM223X100DF1

CAP (μ F)	Rated Voltage (Vn)	Case Code	Φ x h (mm)	TG δ 100Hz	ESR max 100Hz (mOhm)	ESR typ. 100Hz (mOhm)	Z Max 10Khz (mOhm)	I ripple 55°C 100Hz (A)	I ripple 85°C 100Hz (A)	CATALOGUE NUMBER	
										Flat bottom	Mounting stud
470	160	AA	35 x 59	0,09	305	244	206	4,0	2,0	ASM471X160AA1	ASUM471X160AA1
680		AB	35 x 79	0,09	211	169	142	5,0	3,0	ASM681X160AB1	ASUM681X160AB1
1000		AC	35 x 105	0,09	143	115	98	7,0	4,1	ASM102X160AC1	ASUM102X160AC1
1500		BB	51 x 83	0,10	106	85	73	9,0	5,2	ASM152X160BB1	ASUM152X160BB1
2200		BC	51 x 105	0,10	72	58	50	13,0	7,1	ASM222X160BC1	ASUM222X160BC1
3300		CC	63 x 107	0,10	48	39	34	18,0	9,8	ASM332X160CC1	ASUM332X160CC1
4700		DC	76 x 107	0,12	41	33	31	21,0	11,9	ASM472X160DC1	ASUM472X160DC1
6800		DF	76 x 147	0,12	28	22	21	29,0	16,4	ASM682X160DF1	ASUM682X160DF1
10000		DF	76 x 147	0,12	19	15	14	36,0	19,9	ASM103X160DF1	ASUM103X160DF1
15000		DF	76 x 147	0,12	13	10	12	40,5	22,4	ASM153X160DF1	ASUM153X160DF1

CAP (μ F)	Rated Voltage (Vn)	Case Code	Φ x h (mm)	TG δ 100Hz	ESR max 100Hz (mOhm)	ESR typ. 100Hz (mOhm)	Z max 10Khz (mOhm)	I ripple 55°C 100Hz (A)	I ripple 85°C 100Hz (A)	CATALOGUE NUMBER	
										Flat bottom	Mounting stud
330	200	AA	35 x 59	0,08	386	309	248	3,0	1,8	ASM331X200AA1	ASUM331X200AA1
470		AB	35 x 79	0,08	271	217	181	5,0	2,6	ASM471X200AB1	ASUM471X200AB1
680		AC	35 x 105	0,08	187	150	125	6,0	3,6	ASM681X200AC1	ASUM681X200AC1
1000		BB	51 x 83	0,08	127	102	85	9,0	4,7	ASM102X200BB1	ASUM102X200BB1
1500		BC	51 x 105	0,08	85	68	59	12,0	6,6	ASM152X200BC1	ASUM152X200BC1
2200		CC	63 x 107	0,08	58	46	41	16,0	9,0	ASM222X200CC1	ASUM222X200CC1
3300		CC	63 x 107	0,09	43	35	32	19,0	10,4	ASM332X200CC1	ASUM332X200CC1
4700		DC	76 x 107	0,10	34	27	25	23,0	13,1	ASM472X200DC1	ASUM472X200DC1

CAP (μ F)	Rated Voltage (Vn)	Case Code	Φ x h (mm)	TG δ 100Hz	ESR max 100Hz (mOhm)	ESR typ. 100Hz (mOhm)	Z max 10Khz (mOhm)	I ripple 55°C 100Hz (A)	I ripple 85°C 100Hz (A)	CATALOGUE NUMBER	
										Flat bottom	Mounting stud
220	250	AA	35 x 59	0,07	507	405	323	3,0	1,6	ASM221X250AA1	ASUM221X250AA1
330		AB	35 x 79	0,08	386	309	215	4,0	2,2	ASM331X250AB1	ASUM331X250AB1
470		AC	35 x 105	0,08	271	217	165	5,0	3,0	ASM471X250AC1	ASUM471X250AC1
470		BB	51 x 83	0,08	271	217	176	6,0	3,3	ASM471X250BB1	ASUM471X250BB1
680		BB	51 x 83	0,08	187	150	124	7,0	3,9	ASM681X250BB1	ASUM681X250BB1
1000		BC	51 x 105	0,08	127	102	85	10,0	5,4	ASM102X250BC1	ASUM102X250BC1
1500		BC	51 x 105	0,08	85	68	58	12,0	6,6	ASM152X250BC1	ASUM152X250BC1
2200		CC	63 x 107	0,09	65	52	45	15,0	8,5	ASM222X250CC1	ASUM222X250CC1
3300		DC	76 x 107	0,10	48	39	34	20,0	10,9	ASM332X250DC1	ASUM332X250DC1
4700		DF	76 x 147	0,10	34	27	26	27,0	14,4	ASM472X250DF1	ASUM472X250DF1
6800		DJ	76 x 217	0,10	23	19	21	39,0	21,7	ASM682X250DJ1	ASUM682X250DJ1

CAP (μ F)	Rated Voltage (Vn)	Case Code	Φ x h (mm)	TG δ 100Hz	ESR max 100Hz (mOhm)	ESR typ. 100Hz (mOhm)	Z max 10Khz (mOhm)	I ripple 55°C 100Hz (A)	I ripple 85°C 100Hz (A)	CATALOGUE NUMBER	
										Flat bottom	Mounting stud
220	350	AB	35 x 79	0,06	434	347	371	3,0	1,9	ASM221X350AB1	ASUM221X350AB1
330		AC	35 x 105	0,07	338	270	248	5,0	2,5	ASM331X350AC1	ASUM331X350AC1
470		BB	51 x 83	0,07	220	176	180	6,0	3,3	ASM471X350BB1	ASUM471X350BB1
680		BC	51 x 105	0,07	164	131	124	8,0	4,4	ASM681X350BC1	ASUM681X350BC1
1000		BC	51 x 105	0,07	108	87	85	10,0	5,4	ASM102X350BC1	ASUM102X350BC1
1500		CC	63 x 107	0,08	81	65	66	13,0	7,0	ASM152X350CC1	ASUM152X350CC1
2200		DC	76 x 107	0,09	62	50	51	16,0	8,9	ASM222X350DC1	ASUM222X350DC1
3300		DF	76 x 147	0,09	41	33	35	22,0	12,5	ASM332X350DF1	ASUM332X350DF1
4700		DF	76 x 147	0,07	24	19	24	27,0	14,9	ASM472X350DF1	ASUM472X350DF1
6800		DJ	76 x 217	0,10	23	19	20	39,0	21,7	ASM682X350DJ1	ASUM682X350DJ1

CAP (μ F)	Rated Voltage (Vn)	Case Code	Φ x h (mm)	TG δ 100Hz	ESR max 100Hz (mOhm)	ESR typ. 100Hz (mOhm)	Z max 10Khz (mOhm)	I ripple 55°C 100Hz (A)	I ripple 85°C 100Hz (A)	CATALOGUE NUMBER	
										Flat bottom	Mounting stud
220	400	AB	35 x 79	0,08	579	463	369	3,0	1,8	ASM221X400AB1	ASUM221X400AB1
330		AC	35 x 105	0,08	386	309	246	5,0	2,5	ASM331X400AC1	ASUM331X400AC1
470		BB	51 x 79	0,10	339	271	219	5,0	2,9	ASM471X400BB1	ASUM471X400BB1
680		BC	51 x 105	0,10	234	187	151	7,0	4,0	ASM681X400BC1	ASUM681X400BC1
1000		CC	63 x 106	0,10	159	127	105	10,0	5,4	ASM102X400CC1	ASUM102X400CC1
1500		DC	76 x 107	0,10	106	85	72	13,0	7,4	ASM152X400DC1	ASUM152X400DC1
2200		DC	76 x 107	0,11	80	64	51	15,0	8,5	ASM222X400DC1	ASUM222X400DC1
2200		DF	76 x 147	0,10	72	58	51	18,0	10,2	ASM222X400DF1	ASUM222X400DF1
3300		DF	76 x 147	0,12	58	46	35	21,0	11,4	ASM332X400DF1	ASUM332X400DF1
4700		DF	76 x 147	0,12	41	33	35	24,8	13,5	ASM472X400DF1	ASUM472X400DF1
6800		DJ	76 x 217	0,12	28	22	26	30,0	16,4	ASM682X400DJ1	ASUM682X400DJ1

CAP (μ F)	Rated Voltage (Vn)	Case Code	Φ x h (mm)	TG δ 100Hz	ESR max 100Hz (mOhm)	ESR typ. 100Hz (mOhm)	Z max 10Khz (mOhm)	I ripple 55°C 100Hz (A)	I ripple 85°C 100Hz (A)	I ripple CATALOGUE NUMBER	
										Flat bottom	Mounting stud
150	450	AB	35 x 79	0,08	849	679	593	3,0	1,5	ASM151X450AB1	ASUM151X450AB1
220		AC	35 x 105	0,08	579	463	369	4,0	2,1	ASM221X450AC1	ASUM221X450AC1
330		AC	35 x 105	0,08	386	309	246	5,0	2,5	ASM331X450AC1	ASUM331X450AC1
470		BB	51 x 79	0,10	339	271	219	5,0	2,9	ASM471X450BB1	ASUM471X450BB1
680		BC	51 x 105	0,10	234	187	151	7,0	4,0	ASM681X450BC1	ASUM681X450BC1
1000		CC	63 x 106	0,10	159	127	105	10,0	5,4	ASM102X450CC1	ASUM102X450CC1
1500		DC	76 x 107	0,10	106	85	72	13,0	7,4	ASM152X450DC1	ASUM152X450DC1
2200		DC	76 x 107	0,10	72	58	51	16,0	8,9	ASM222X450DC1	ASUM222X450DC1
2200		DF	76 x 147	0,10	72	58	49	18,0	10,2	ASM222X450DF1	ASUM222X450DF1
3300		DF	76 x 147	0,12	58	46	39	21,0	11,4	ASM332X450DF1	ASUM332X450DF1
4700		DJ	76 x 217	0,12	41	33	29	30,0	16,4	ASM472X450DJ1	ASUM472X450DJ1
5600		DF	76 x 147	0,12	34	27	29	30,0	16,4	ASM562X450DF1	ASUM562X450DF1
5600		DJ	76 x 217	0,13	37	30	28	31,0	17,2	ASM562X450DJ1	ASUM562X450DJ1

CAP (μ F)	Rated Voltage (Vn)	Case Code	Φ x h (mm)	TG δ 100Hz	ESR max 100Hz (mOhm)	ESR typ. 100Hz (mOhm)	Z max 10Khz (mOhm)	I ripple 55°C 100Hz (A)	I ripple 85°C 100Hz (A)	CATALOGUE NUMBER	
										Flat bottom	Mounting stud
1000	500	BC	51 X 105	0,10	159	127	98	8,0	4,2	ASM102X500BC1	ASUM102X500BC1
1500		DC	76 x 107	0,10	106	85	74	11,0	6,0	ASM152X500DC1	ASUM152X500DC1
2200		DF	76 x 147	0,10	72	58	47	15,0	8,3	ASM222X500DF1	ASUM222X500DF1
3300		DF	76 x 147	0,10	48	39	27	16,0	9,1	ASM332X500DF1	ASUM332X500DF1
4700		DF	76 x 147	0,08	27	22	31	27,0	15,4	ASM472M500DF1	ASUM472M500DF1
4700		EF	76 X 217	0,08	27	22	31	30,1	17,2	ASM472M500EF1	ASUM472M500EF1