



N. 521400

foglio 1 di 1

DATA SHEET
FOGLIO DATI

Approval Walter Cerutti
Verified Mauro Pellegatta

Revision 0 09/11/03

Emission DT 09/11/03

Resistenza smaltata a nastro ondulato
mod. RNO/TI (regolabile RNOR)

Corrugated tape vitreous resistor style
RNO/TI (adjustable RNOR)

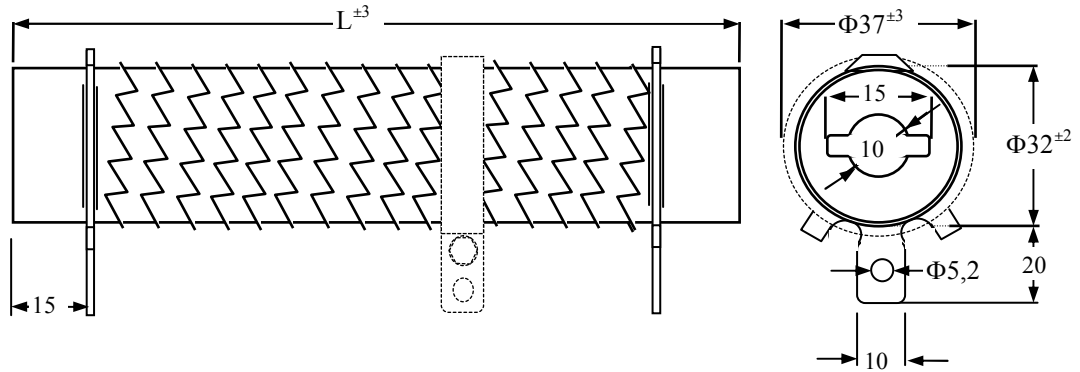

1. Resistore modello RNO/TI	29.108	29.165	29.215	29.265	29.300	RNO Resistor style
2. Dimensione "L"	108 mm	165 mm	215 mm	265 mm	300 mm	Dimension "L"
3. Potenza nomin. a 25°C (P _R)	155 W	240 W	300 W	370 W	420 W	Rated power @ 25°C (P _R)
4. Gamma dei valori resistivi	0,068 Ω ÷ 10Ω	0,12 Ω ÷ 25Ω	0,18 Ω ÷ 30Ω	0,22 Ω ÷ 43Ω	0,24 Ω ÷ 47Ω	Resistance range
5. Tolleranza	± 10% ± 5% (0+15% RNOR)					Resistance tolerance
6. Temperatura superficiale ammissibile	450°C max					Surface temperature limit
7. Tensione Limite	1.500 V	2.000 V	2.500 V	3.000 V	3.000 V	Limiting element voltage
8. Sovraccarico	10P _R for 5" max					Overload

7. Incremento della temperatura superficiale in funzione del carico

Surface temperature rise related to power dissipation.

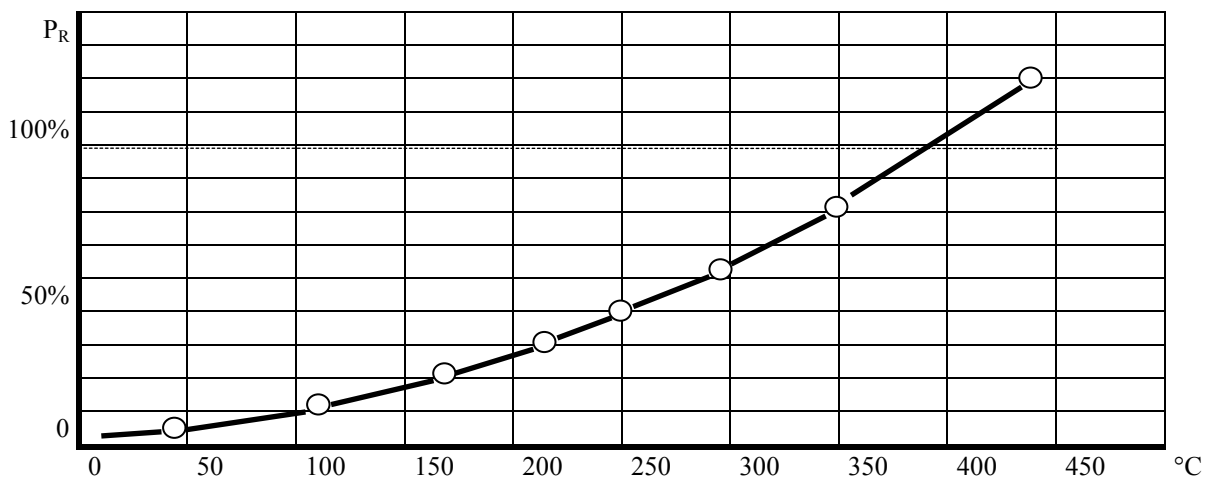

8. Dispositivi di montaggio modello SB-SC 23

Mountng bracket style SB-SC 23

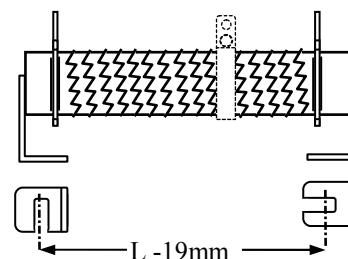
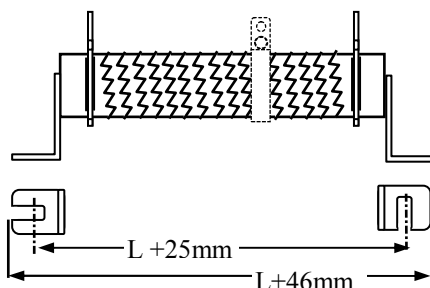

S.I.R. Società Italiana Resistor
I 21053 Castellanza - Via Isonzo 13
Tel.0331.504.828 - Fax 0331.504.565





N. 521050

foglio 1 di 1

FOGLIO DATI
DATA SHEET

Approval Walter Cerutti
Verified Mauro Pellegatta
Revision 0 3.7.1998
Emission DT 3.7.1998

Resistenza smaltata a nastro odulato
mod. RNO (regolabile RNOR)

Corrugated tape vitreous resistor style
RNO (adjustable RNOR)

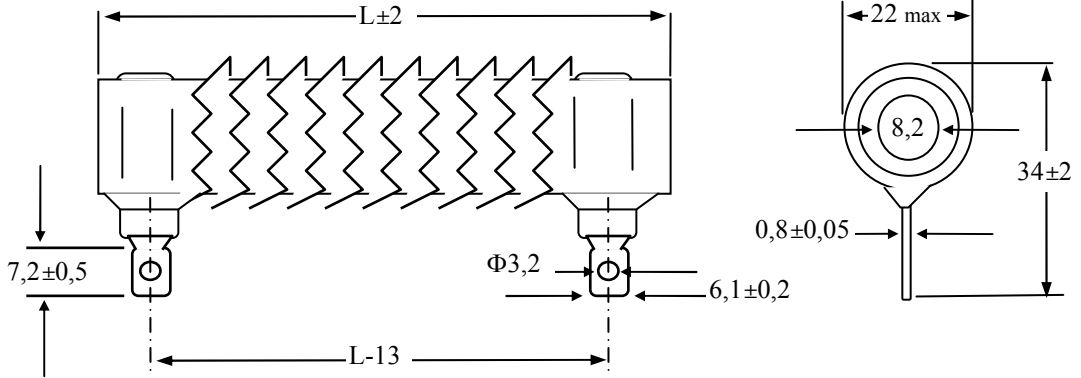

1. Resistore modello	RNO	14.51	14.76	14.102	14.152	RNO Resistor style
2. Dimensione "L"		51 mm	76 mm	102 mm	152 mm	Dimension "L"
3. Potenza nomin. a 25°C (P _R)		35 W	45 W	75 W	100 W	Rated power @ 25°C (P _R)
4. Gamma dei valori resistivi		0,033Ω±5Ω	0,047Ω±8Ω	0,068Ω±12Ω	0,082Ω±15Ω	Resistance range
5. Tolleranza		± 10% ± 5% (0+15% RNOR)				Resistance tolerance
6. Temperatura superficiale ammissibile		450°C max				Surface temperature limit
7. Tensione Limite		750 V	1.000 V	1.500 V	1.800 V	Limiting element voltage
8. Sovraccarico		10P _R for 5" max				Overload

7. Incremento della temperatura superficiale
in funzione del carico

Surface temperature rise related to
power dissipation.

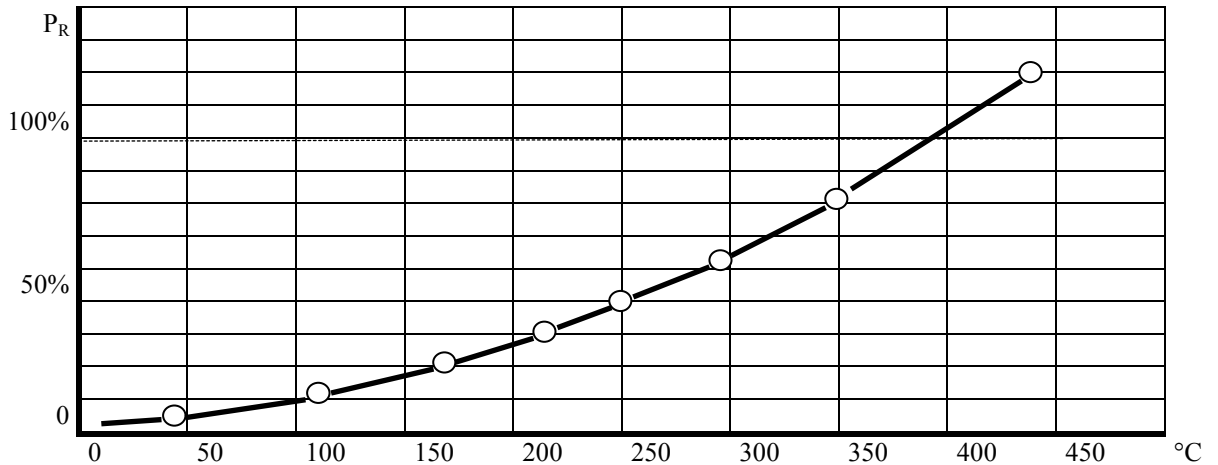

8. Dispositivi di montaggio modello SB-SC 13

Mountng bracket style SB-SC 13

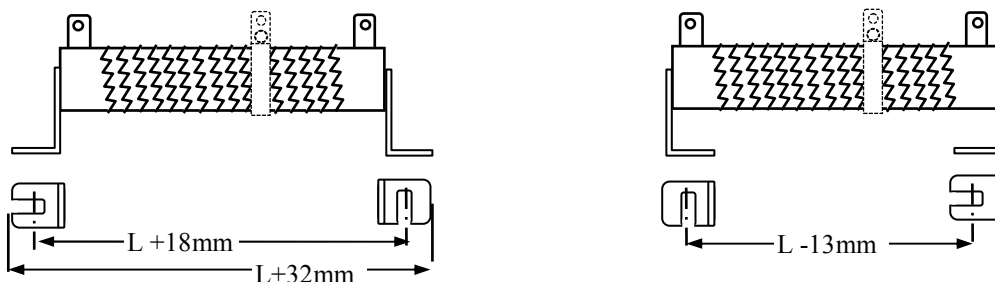

S.I.R. Società Italiana Resistor
I 21053 Castellanza - Via Isonzo 13
Tel.0331.504.828 - Fax 0331.504.565





N. 521150

foglio 1 di 1

FOGLIO DATI DATA SHEET

Approval Walter Cerutti
Verified Mauro Pellegatta

Revision 2 21/06/00
Emission DT 14/06/00

Resistenza smaltata a nastro odulato mod. RNO (regolabile RNOR)

Corrugated tape vitreous resistor style RNO (adjustable RNOR)

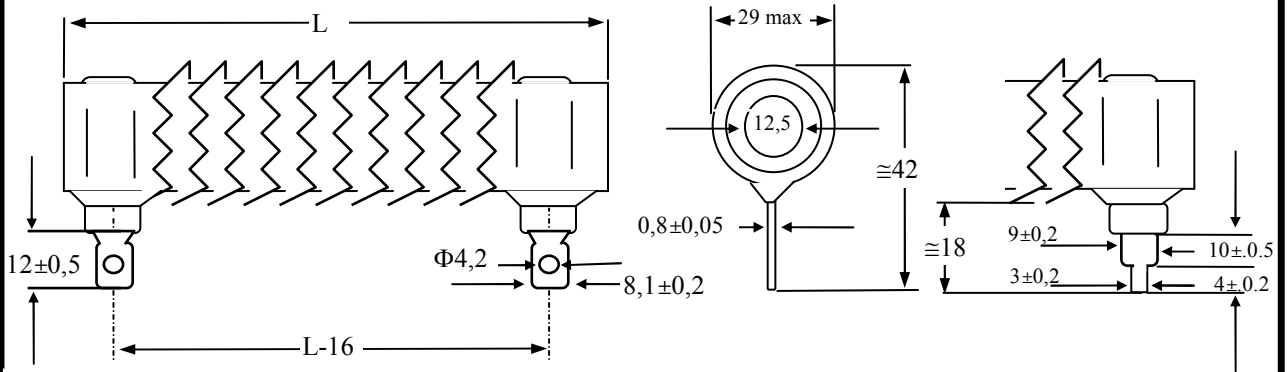

1. Resistore modello	RNO	20.80	20.100	20.165	20.265	RNO Resistor style
2. Dimensione "L"		80±1.2 mm	100±1.6 mm	165±2 mm	265±3 mm	Dimension "L"
3. Potenza nomin. a 25°C (P _R)		75 W	100 W	140 W	250 W	Rated power @ 25°C(P _R)
4. Gamma dei valori resistivi		0,047Ω±6Ω	0,068Ω±10Ω	0,082Ω±18Ω	0,082Ω±15Ω	Resistance range
5. Tolleranza		± 10% ± 5% (0+15% RNOR)				Resistance tolerance
6. Temperatura superficiale ammissibile		450°C max				Surface temperature limit
7. Tensione Limite		900 V	1.200 V	1.800 V	2.500 V	Limiting element voltage
8. Sovraccarico		10P _R for 5" max				Overload

7. Incremento della temperatura superficiale in funzione del carico

Surface temperature rise related to power dissipation.

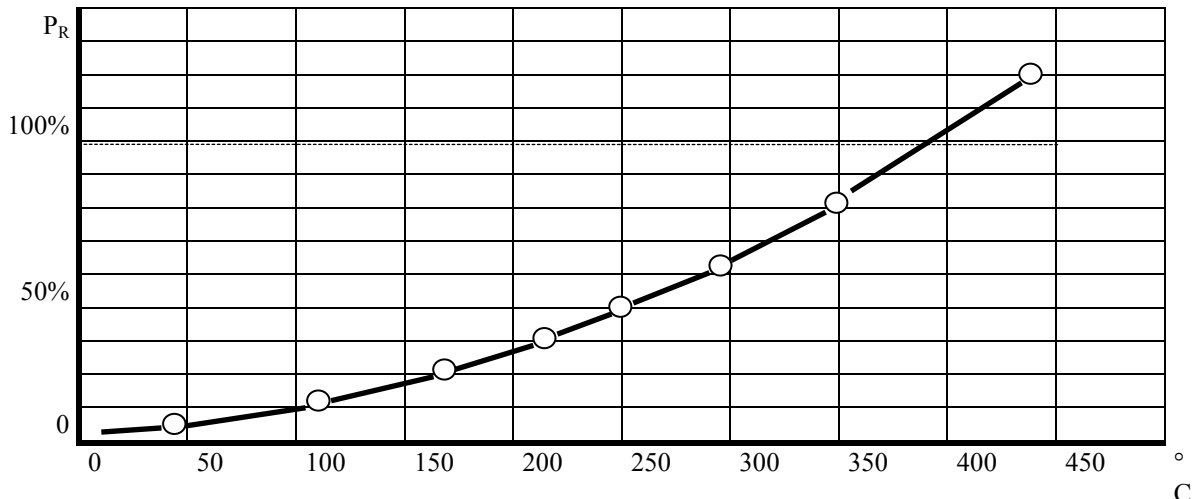

8. Dispositivi di montaggio modello SB-SC 23

Mounting bracket style SB-SC 23

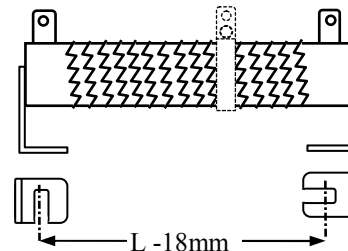
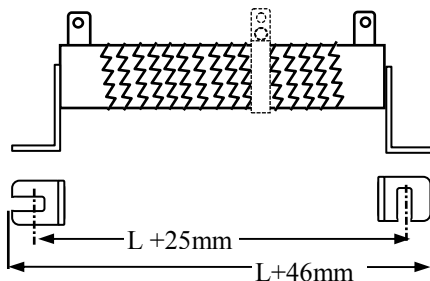

S.I.R. Società Italiana Resistor
I 21053 Castellanza - Via Isonzo 13
Tel.0331.504.828 - Fax 0331.504.565





Resistenza smaltata fissa di
potenza mod. RNO

Fixed power vitreous resistor style
RNO

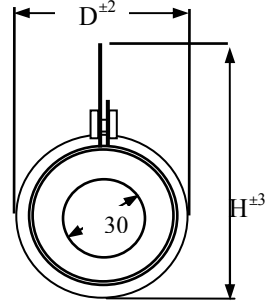
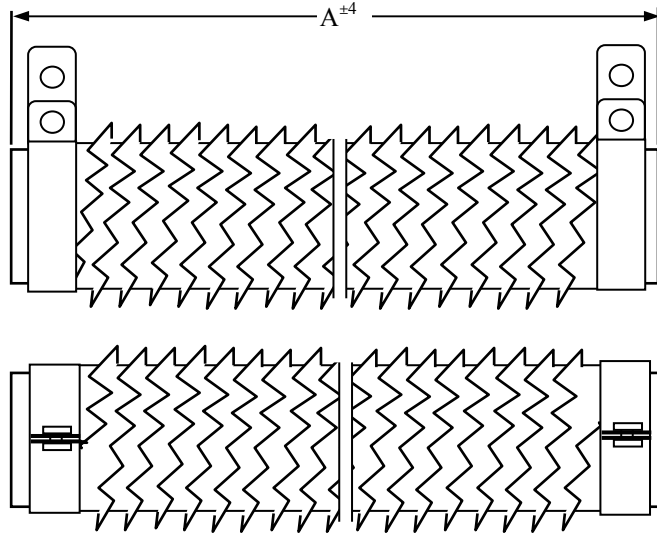

1. Resistore mod.	RNO/TA 42.362	RNO/TA 50.373	Resistor style	
2. Dimensioni	A±4 D±3 H±3	362 48 65	373 56 73	A±4 Dimensions D±3 H±3
3. Gamma dei valori resistivi	0,33 ÷ 56		0,39 ÷ 68	Resistance range
4. Tolleranza	± 10%		± 5% (0+15% RNOR)	Resist. tolerance
5. Temperatura superf. ammessa	450°C max			Surface temperature limit
6. Tensione Limite	4.500 V	5.000 V		Limiting element voltage
7. Sovraccarico	10P _R for 5" max			Overload
8. Potenza @ 25°C(P _R)	700 W	1.000 W		Rated power @ 25°C
9. Potenza massima @ 25°C	850 W	1.200 W		Maximum power @ 25°C

10. Incremento della temperatura superficiale
in funzione del carico

Surface temperature rise related to
power dissipation.

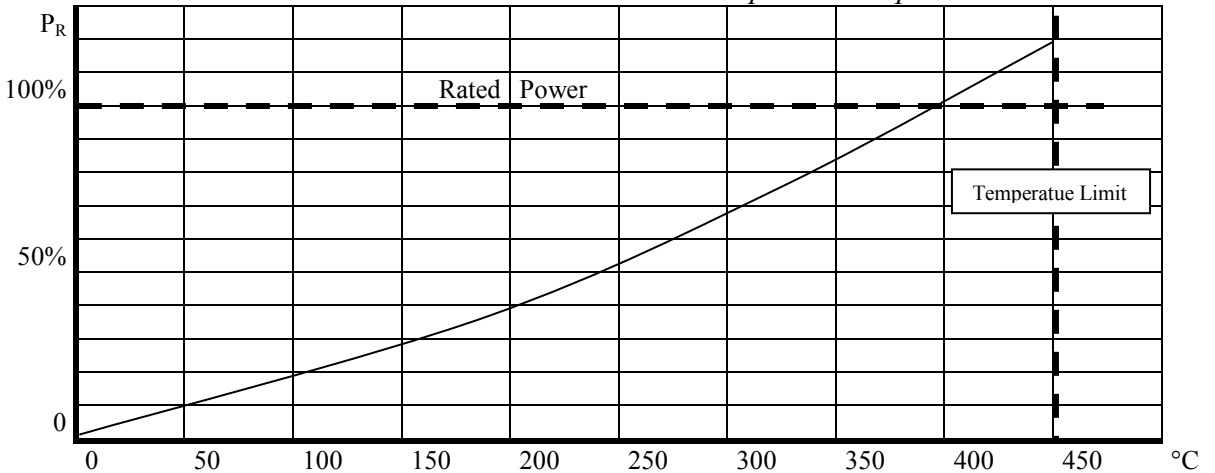

11. Dispositivi di montaggio modello SO
Mountng bracket style SO

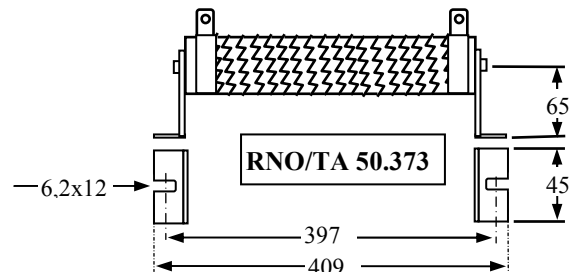
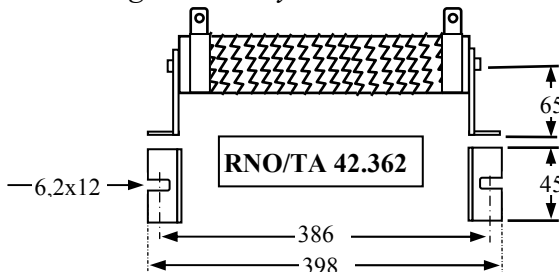

S.I.R. Società Italiana Resistor
I 21053 Castellanza - Via Isonzo 13
Tel.0331.504.828 - Fax 0331.504.565





Resistenza smaltata fissa di potenza
mod. RNO 65.xxx (regolabile RNOR 65.xxx)

Fixed power vitreous resistor style
RNO 65.xxx (adjustable RNOR 65.xxx)

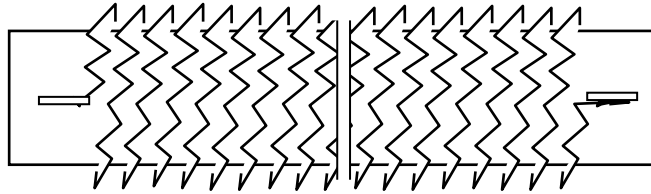
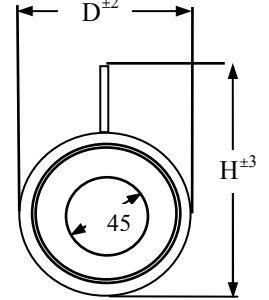
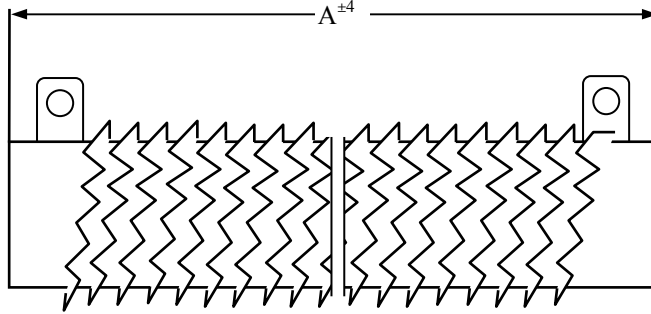

1. Resistore mod.		RNO 65.300	RNO 65.400	RNO 65.500	Resistor style
2. Dimensioni	A±3	300	400	500	A±3 Dimensions
	D±3	74	74	74	D±3
	H±3	88	88	88	H±3
3. Gamma valori resistivi		0,56 ÷ 68	0,82 ÷ 82	1 ÷ 100	Resistance range
4. Tolleranza		± 10% ± 5% (0+15% RNOR)			Resist. tolerance
5. Temperatura superf. ammissa		450°C max			Surface temperature limit
6. Tensione Limite		3000 V	3.500 V	4.000 V	Limiting element voltage
7. Sovraccarico		10P _R for 5" max			Overload
8. Potenza @ 25°C(P _R)		750 W	1.000 W	1.500 W	Rated power @ 25°C
9. Potenza massima @ 25°C		800 W	1.100 W	1.600 W	Maximum power @ 25°C

10. Incremento della temperatura superficiale in funzione del carico

Surface temperature rise related to power dissipation.

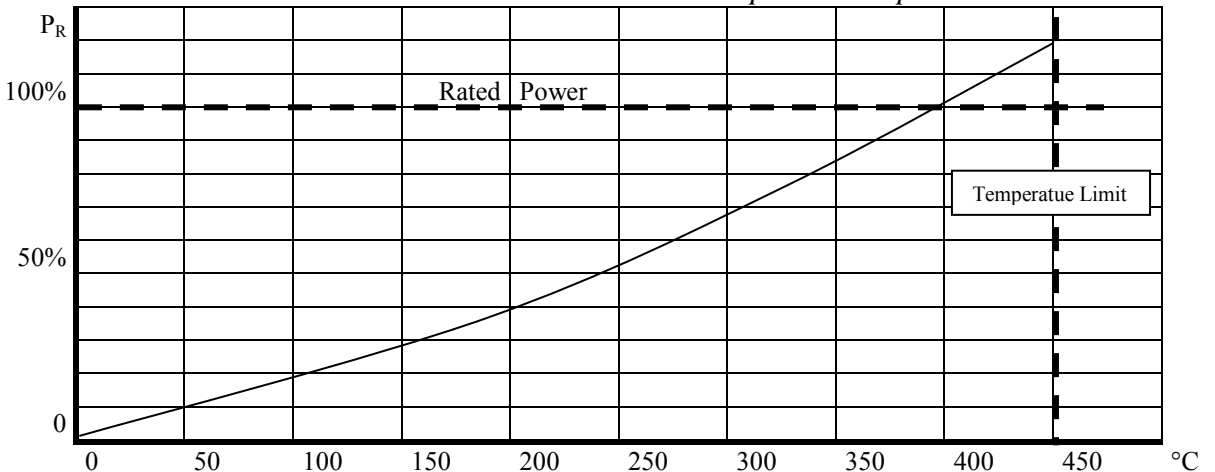

11. Dispositivi di montaggio modello SO

Mountng bracket style SO

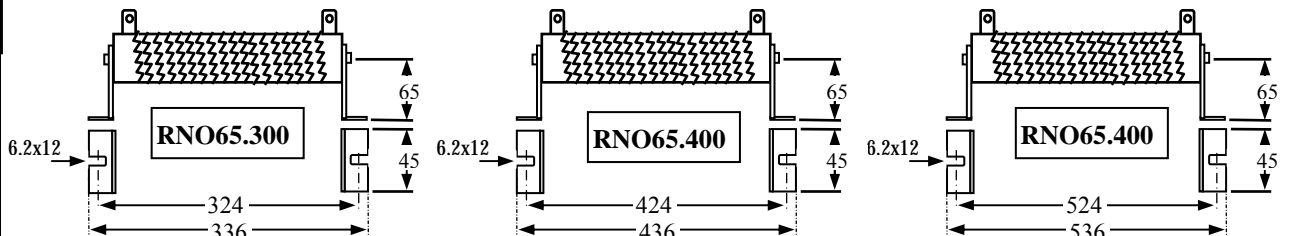

S.I.R. Società Italiana Resistor
I 21053 Castellanza - Via Isonzo 13
Tel.0331.504.828 - Fax 0331.504.565





N. 520910

foglio 1 di 1

DATA SHEET FOGLIO DATI

Approval Walter Cerutti
Verified Mauro Pellegatta

Revision 0 4.11.1996

Emission DT 4.11.1996

**Resistenza smaltata a nastro odulato
mod. RNO (regolabile RNOR)**

*Corrugated tape vitreous resistor style
RNO (adjustable RNOR)*

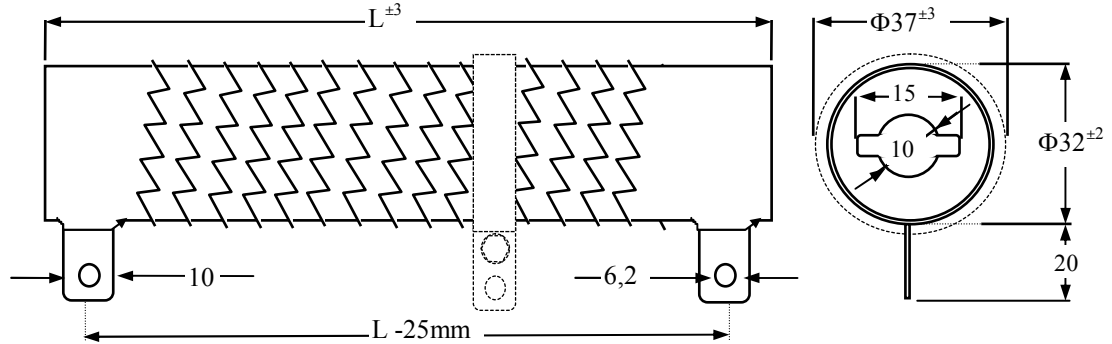

1. Resistore modello	RNO	29.108	29.165	29.215	29.265	29.300	RNO Resistor style
2. Dimensione "L"		108 mm	165 mm	215 mm	265 mm	300 mm	Dimension "L"
3. Potenza nomin. a 25°C (P _R)		155 W	240 W	300 W	370 W	420 W	Rated power @ 25°C (P _R)
4. Gamma dei valori resistivi		0,068 Ω ÷ 10Ω	0,12 Ω ÷ 25Ω	0,18 Ω ÷ 30Ω	0,22 Ω ÷ 43Ω	0,24 Ω ÷ 47Ω	Resistance range
5. Tolleranza		± 10% ± 5% (0+15% RNOR)					Resistance tolerance
6. Temperatura superficiale ammissibile		450°C max					Surface temperature limit
7. Tensione Limite		1.500 V	2.000 V	2.500 V	3.000 V	3.000 V	Limiting element voltage
8. Sovraccarico		10P _R for 5" max					Overload

7. Incremento della temperatura superficiale in funzione del carico

Surface temperature rise related to power dissipation.

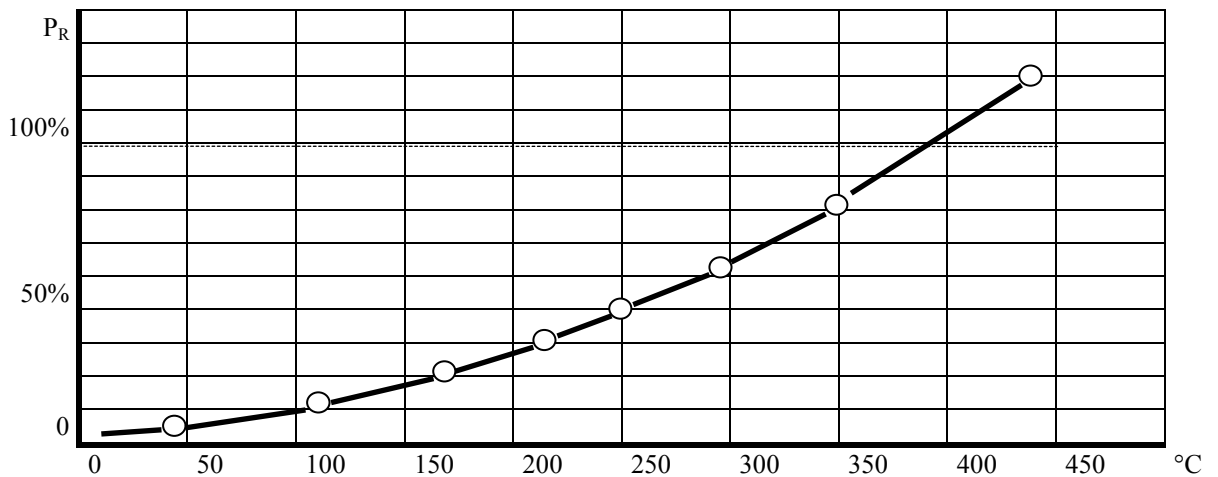

8. Dispositivi di montaggio modello SB-SC 23

Mountng bracket style SB-SC 23

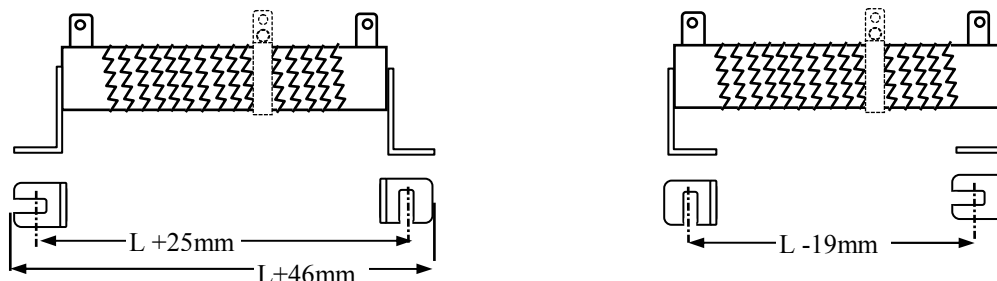

S.I.R. Società Italiana Resistor
I 21053 Castellanza - Via Isonzo 13
Tel. 0331.504.828 - Fax 0331.504.565



S.I.R. Società Italiana Resistor
 I 21053 Castellanza - Via Isonzo 13
 Tel.0331.504.828 - Fax 0331.504.565

Resistenza cementata di potenza mod.
RNOC 65.xxx (regolabile RNOCR 65.xxx)

Cemented power resistor style
RNOC 65.xxx (adjustable RNOCR 65.xxx)

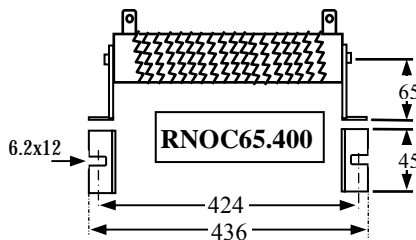
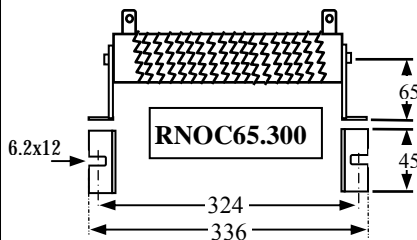
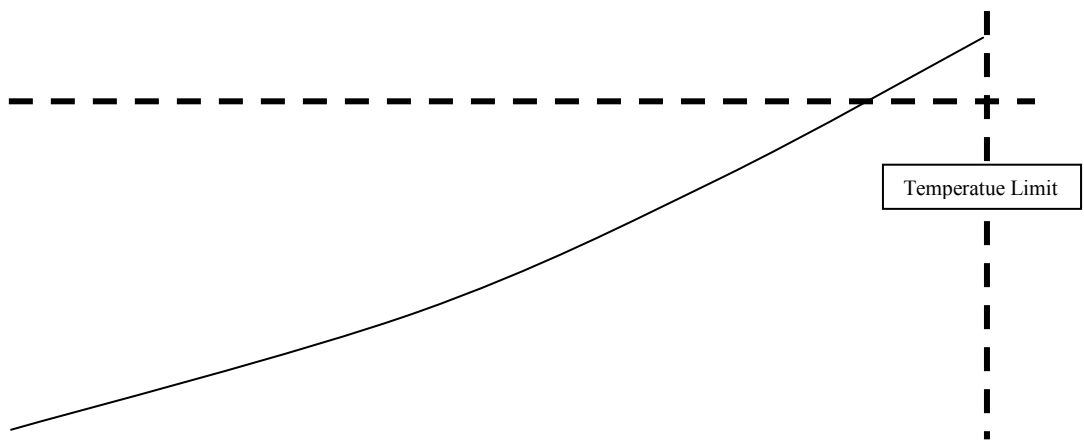
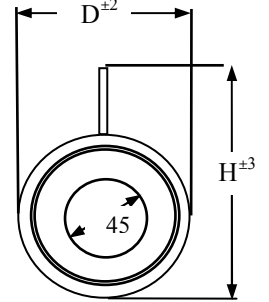
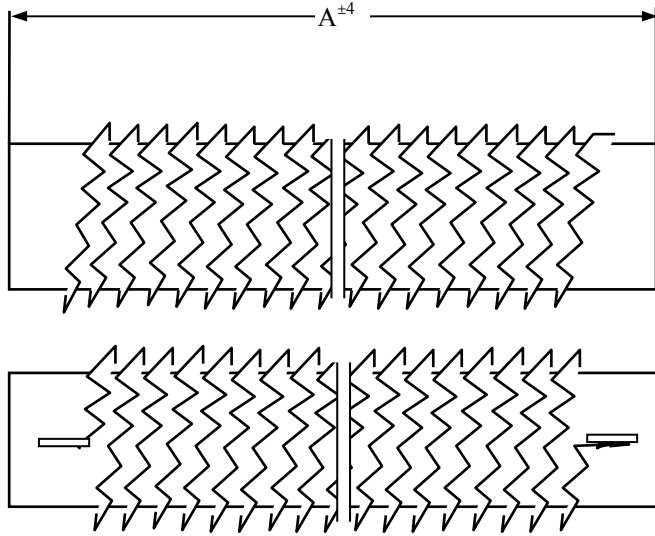

RNOC65.500