

K19

Peso Kg/m  
Weight Kg/m

0.15

Rt °C/W 9

Lung. campione mm  
Sample length mm 50

A

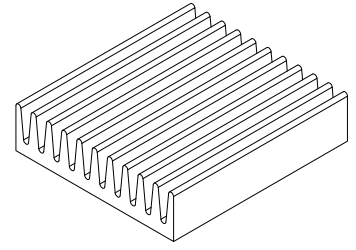
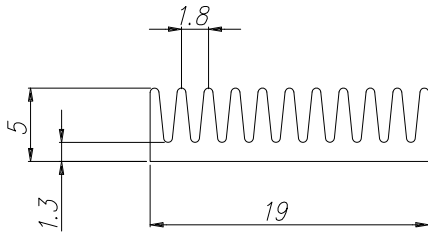

ATECNAL  
BOLOGNA - ITALY

K30

Peso Kg/m  
Weight Kg/m

1.04

Rt °C/W 4.8

Lung. campione mm  
Sample length mm 100

B

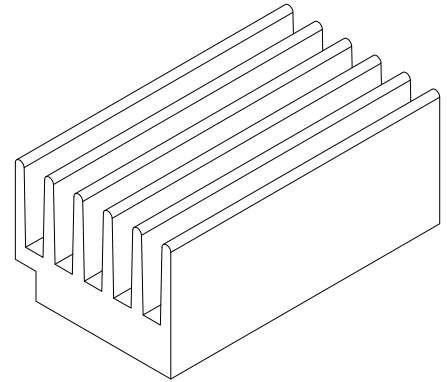
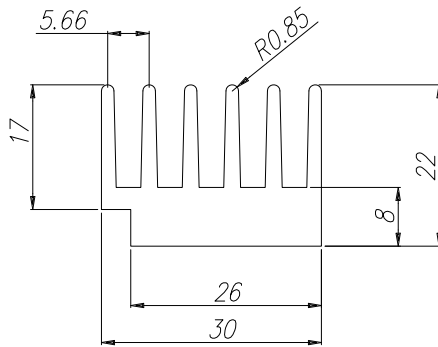

ATECNAL  
BOLOGNA - ITALY

KE30

Peso Kg/m  
Weight Kg/m

--

Rt °C/W --

Lung. campione mm  
Sample length mm 100

C

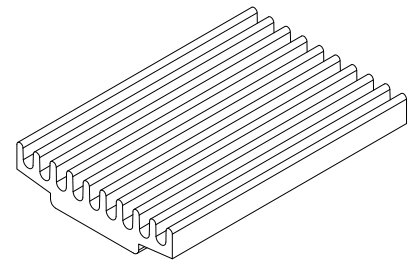
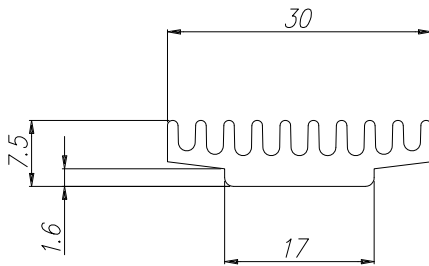

ATECNAL  
BOLOGNA - ITALY

K34

Peso Kg/m  
Weight Kg/m 2.35

Rt °C/W 1.5

Lung. campione mm  
Sample length mm 150

D

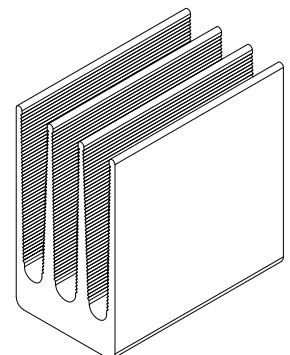
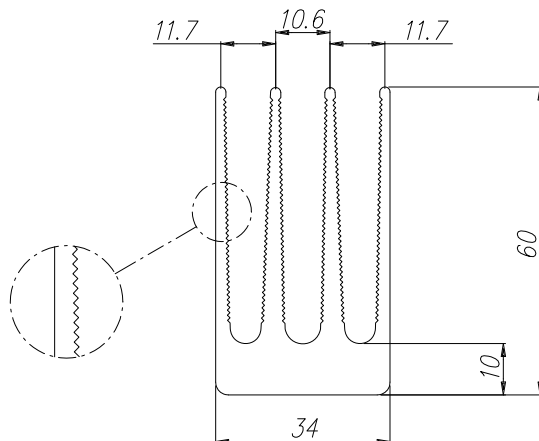

ATECNAL  
BOLOGNA - ITALY

KE34

Peso Kg/m  
Weight Kg/m 1.68

Rt °C/W --

Lung. campione mm  
Sample length mm --

A

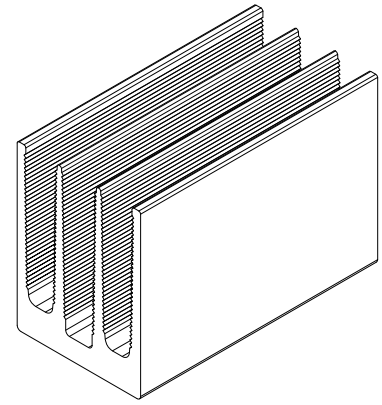
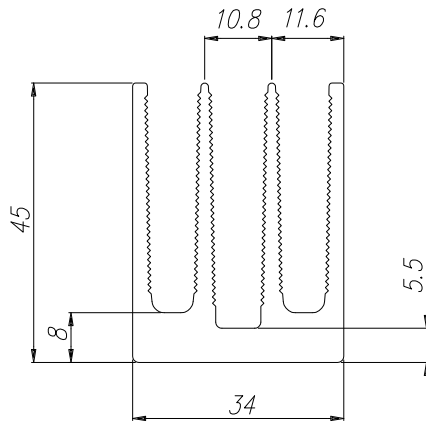

ATECNAL  
BOLOGNA - ITALY

K38

Peso Kg/m  
Weight Kg/m 2.40

Rt °C/W 2.4

Lung. campione mm  
Sample length mm 100

B

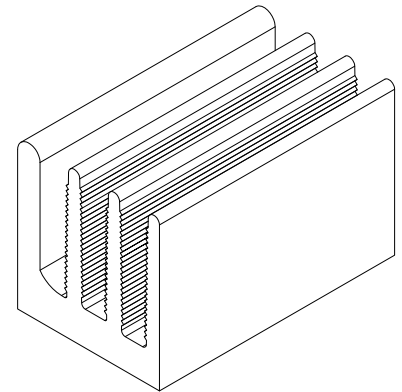
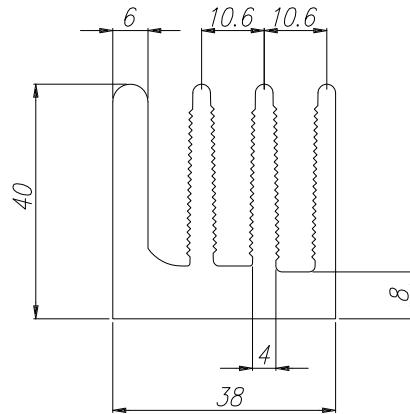

ATECNAL  
BOLOGNA - ITALY

K40

Peso Kg/m  
Weight Kg/m 1.53

Rt °C/W 3.9

Lung. campione mm  
Sample length mm 100

C

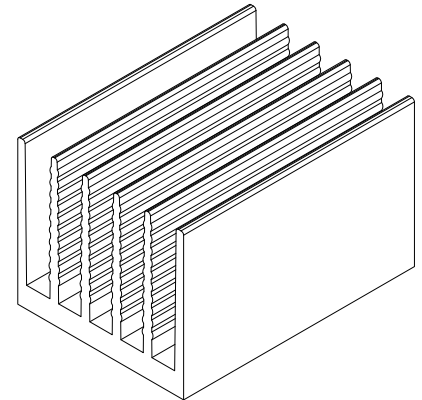
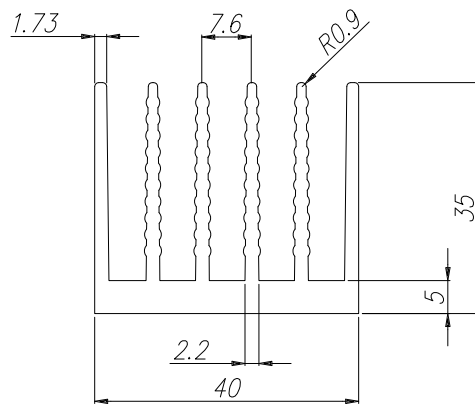

ATECNAL  
BOLOGNA - ITALY

K42

Peso Kg/m  
Weight Kg/m 1.80

Rt °C/W 2.0

Lung. campione mm  
Sample length mm 100

D

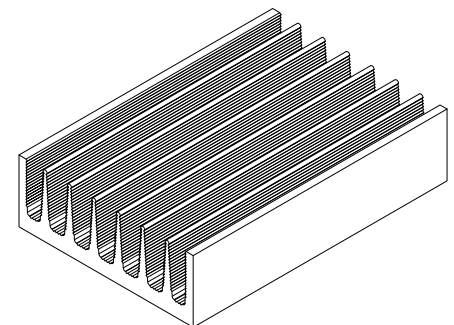
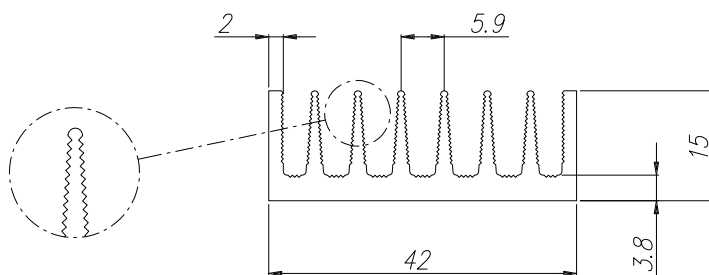

ATECNAL  
BOLOGNA - ITALY

A

**K48**

Peso Kg/m  
Weight Kg/m 2.00

Rt °C/W 2.1

Lung. campione mm  
Sample length mm 100

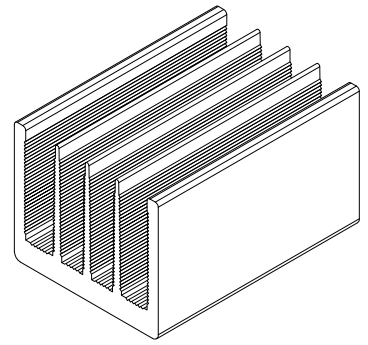
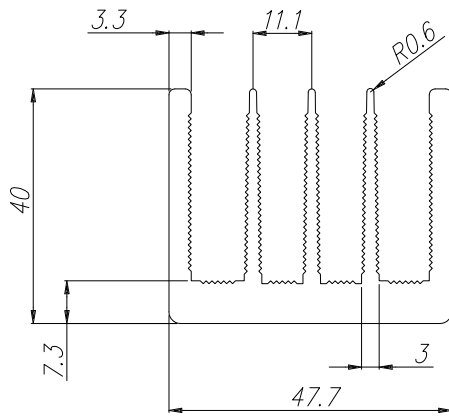

ATECNAL  
BOLOGNA - ITALY

B

**K52**

Peso Kg/m  
Weight Kg/m 2.50

Rt °C/W 2.0

Lung. campione mm  
Sample length mm 100

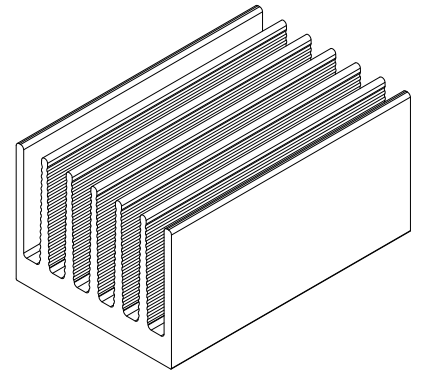
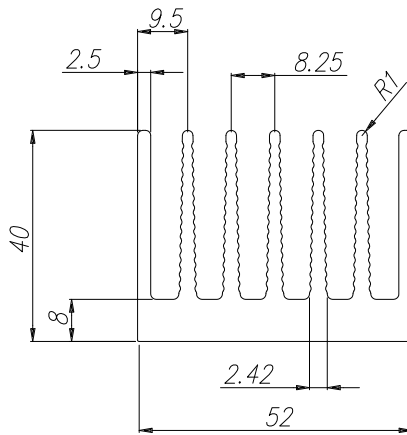

ATECNAL  
BOLOGNA - ITALY

C

**K56**

Peso Kg/m  
Weight Kg/m 2.50

Rt °C/W 2.0

Lung. campione mm  
Sample length mm 100

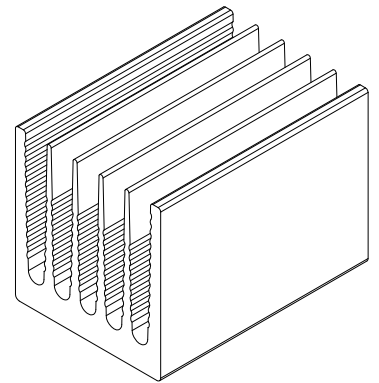
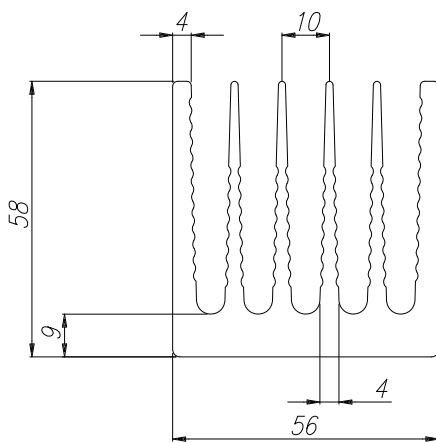

ATECNAL  
BOLOGNA - ITALY

D

**K65**

Peso Kg/m  
Weight Kg/m 2.50

Rt °C/W 2.0

Lung. campione mm  
Sample length mm 100

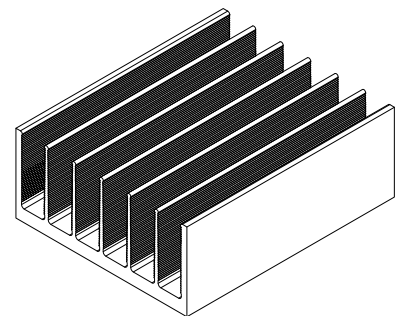
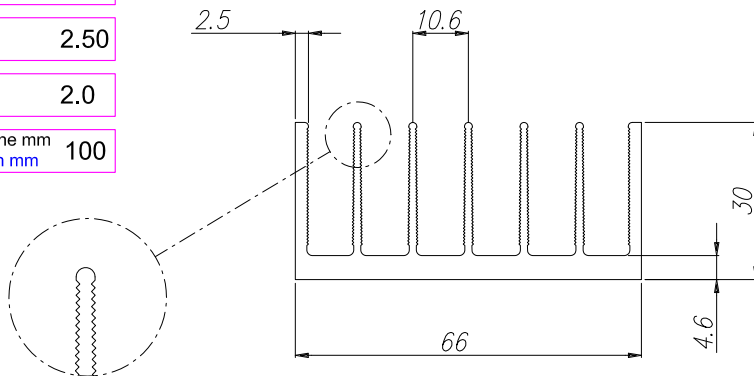

ATECNAL  
BOLOGNA - ITALY

**A**

<b>K66</b>	
Peso Kg/m Weight Kg/m	2.50
Rt °C/W	2.0
Lung. campione mm Sample length mm	100

Technical drawing of heat sink K66. Dimensions: 3, 10.1, 3, 66, 7.5, 40. Includes a 3D perspective view and a circular detail of the fin profile.

**ATECNAL**  
BOLOGNA - ITALY

**B**

<b>K66B</b>	
Peso Kg/m Weight Kg/m	3.40
Rt °C/W	1.65
Lung. campione mm Sample length mm	100

Technical drawing of heat sink K66B. Dimensions: 4, 10.1, 9, 66, 40. Includes a 3D perspective view and a circular detail of the fin profile.

**ATECNAL**  
BOLOGNA - ITALY

**C**

<b>K72</b>	
Peso Kg/m Weight Kg/m	3.10
Rt °C/W	1.95
Lung. campione mm Sample length mm	100

Technical drawing of heat sink K72. Dimensions: 6, 5, 1.5, 72, 9, 30. Includes a 3D perspective view and a circular detail of the fin profile.

**ATECNAL**  
BOLOGNA - ITALY

**D**

<b>K76</b>	
Peso Kg/m Weight Kg/m	2.23
Rt °C/W	2.20
Lung. campione mm Sample length mm	100

Technical drawing of heat sink K76. Dimensions: 3.1, 1, 76, 26, 3. Includes a 3D perspective view.

**ATECNAL**  
BOLOGNA - ITALY

A

**K82**

Peso Kg/m  
Weight Kg/m 2.71

Rt °C/W 1.60

Lung. campione mm  
Sample length mm 100

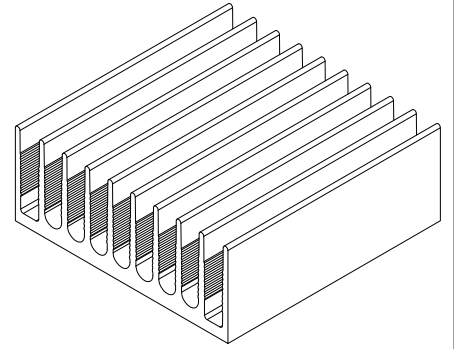
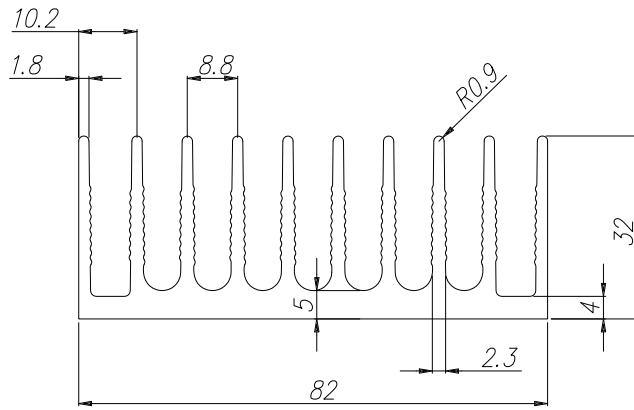

ATECNAL  
BOLOGNA - ITALY

B

**KE82**

Peso Kg/m  
Weight Kg/m 2.74

Rt °C/W 1.60

Lung. campione mm  
Sample length mm 100

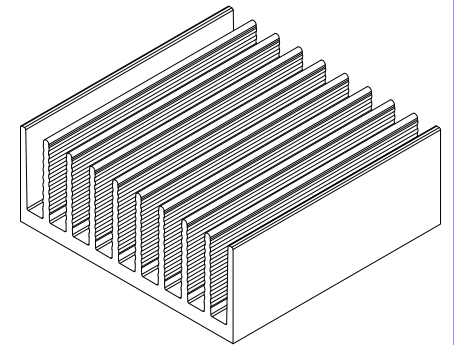
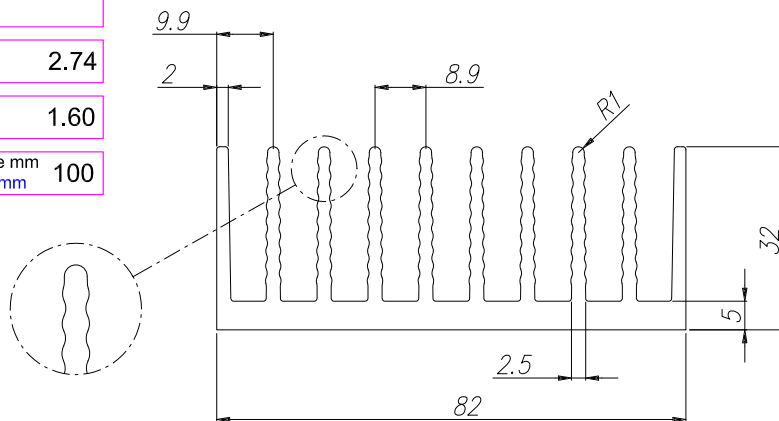

ATECNAL  
BOLOGNA - ITALY

C

**KEA82**

Peso Kg/m  
Weight Kg/m 5.00

Rt °C/W 1.10

Lung. campione mm  
Sample length mm 100

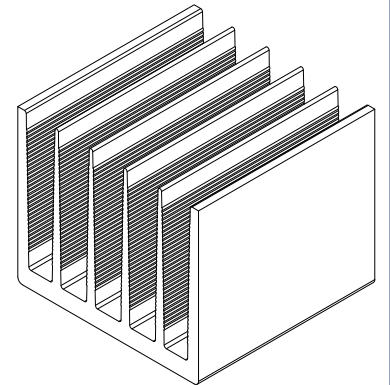
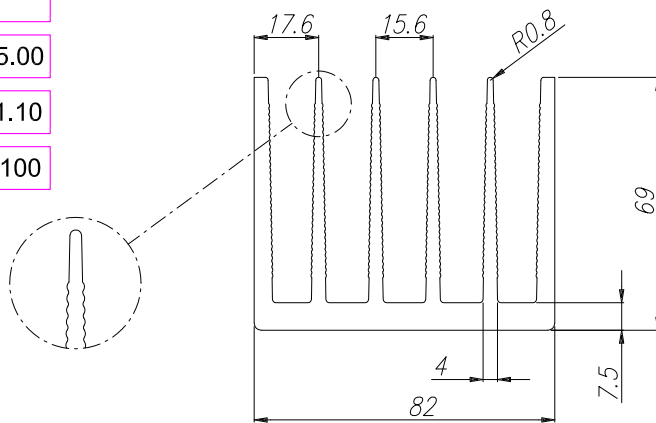

ATECNAL  
BOLOGNA - ITALY

D

**K100A**

Peso Kg/m  
Weight Kg/m 5.00

Rt °C/W 1.10

Lung. campione mm  
Sample length mm 100

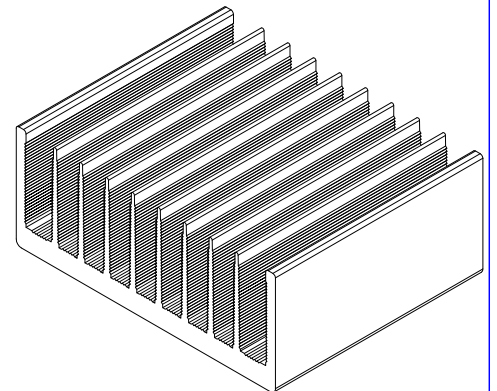
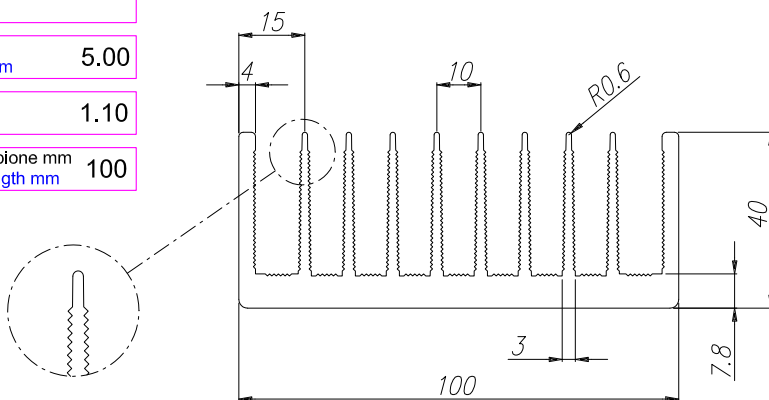

ATECNAL  
BOLOGNA - ITALY

**A**

<b>K100H</b>	
Peso Kg/m Weight Kg/m	4.80
Rt °C/W	1.10
Lung. campione mm Sample length mm	100

TECNODAL  
BOLOGNA - ITALY

**B**

<b>K100X</b>	
Peso Kg/m Weight Kg/m	4.90
Rt °C/W	1.10
Lung. campione mm Sample length mm	100

TECNODAL  
BOLOGNA - ITALY

**C**

<b>KE100</b>	Peso Kg/m Weight Kg/m	2.15	Rt °C/W	3.0	Lung. campione mm Sample length mm	100
--------------	--------------------------	------	---------	-----	---------------------------------------	-----

TECNODAL  
BOLOGNA - ITALY

**D**

<b>K112</b>	
Peso Kg/m	8.70
Rt °C/W	0.90
Lung. campione mm Sample length mm	100

TECNODAL  
BOLOGNA - ITALY

K113

Peso Kg/m  
Weight Kg/m

3.40

Rt °C/W

1.30

Lung. campione mm  
Sample length mm

100

A

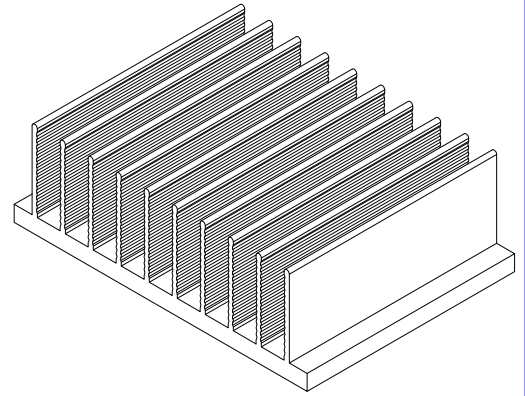
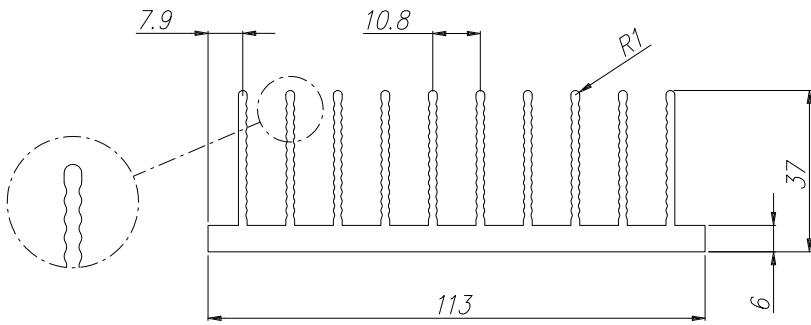

ATECNAL  
BOLOGNA - ITALY

K120

Peso Kg/m  
Weight Kg/m

8.10

Rt °C/W

0.90

Lung. campione mm  
Sample length mm

100

B

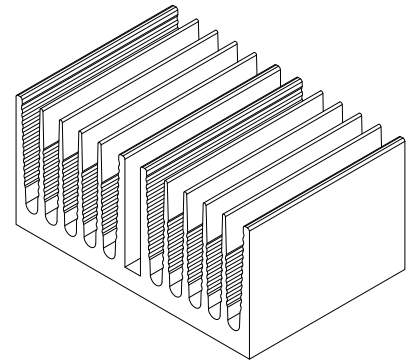
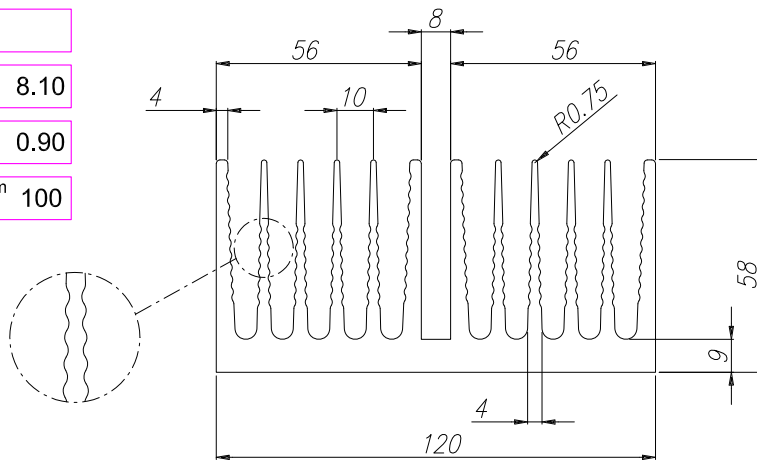

ATECNAL  
BOLOGNA - ITALY

K120L

Peso Kg/m  
Weight Kg/m

8.10

Rt °C/W

0.90

Lung. campione mm  
Sample length mm

100

C

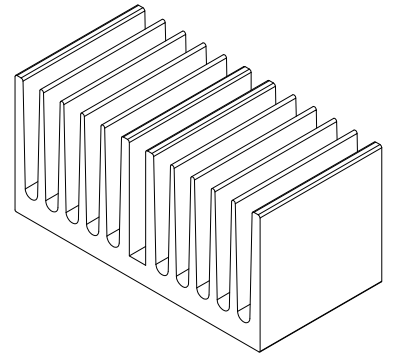
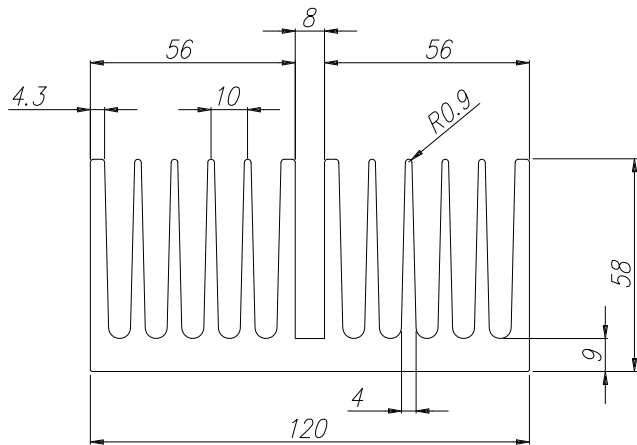

ATECNAL  
BOLOGNA - ITALY

K127

Peso Kg/m  
Weight Kg/m

3.40

Rt °C/W

1.30

Lung. campione mm  
Sample length mm

100

D

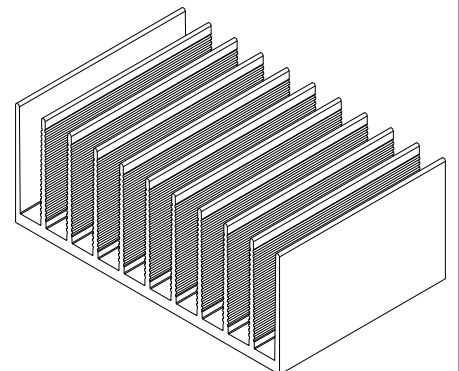
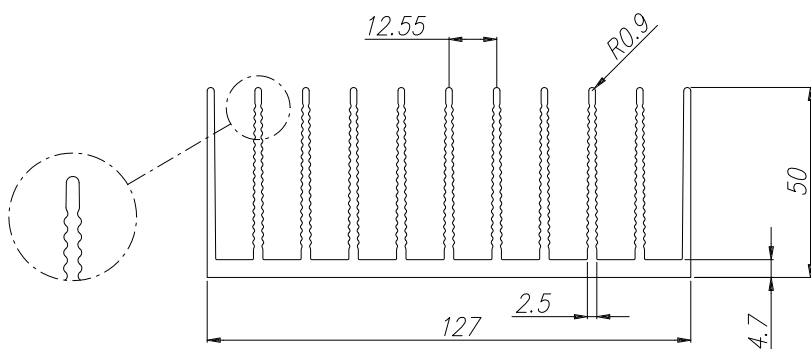

ATECNAL  
BOLOGNA - ITALY

K134

Peso Kg/m  
Weight Kg/m 2.40

Rt °C/W 1.20

Lung. campione mm  
Sample length mm 150

A

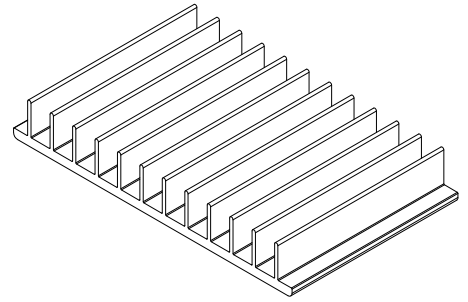
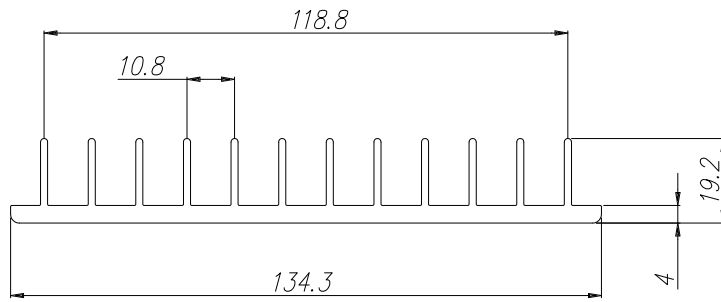

ATECNAL  
BOLOGNA - ITALY

K135

Peso Kg/m  
Weight Kg/m 3.10

Rt °C/W 1.15

Lung. campione mm  
Sample length mm 150

B

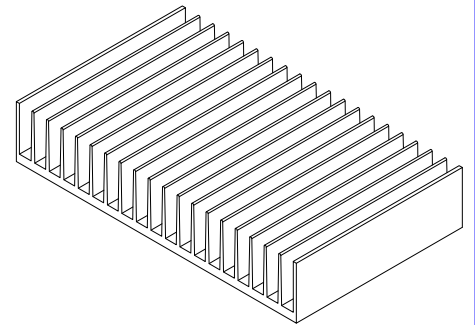
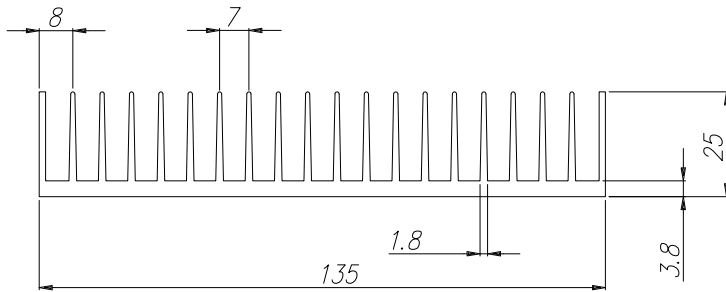

ATECNAL  
BOLOGNA - ITALY

KXH140

Peso Kg/m  
Weight Kg/m 23.7

Rt °C/W 0.30

Lung. campione mm  
Sample length mm 200

C

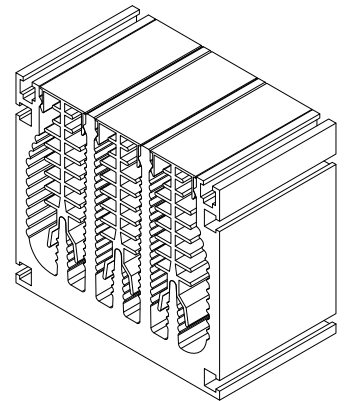
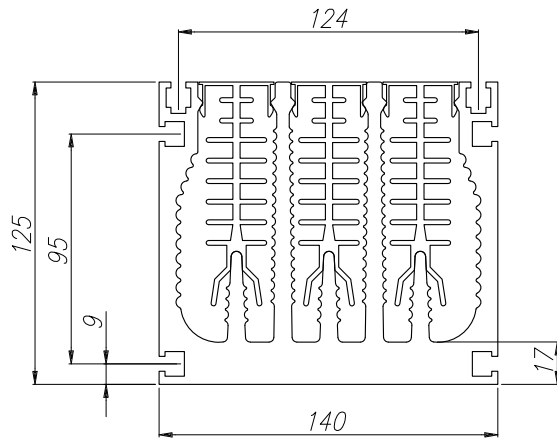

ATECNAL  
BOLOGNA - ITALY

K150

Peso Kg/m  
Weight Kg/m 5.10

Rt °C/W 0.90

Lung. campione mm  
Sample length mm 150

D

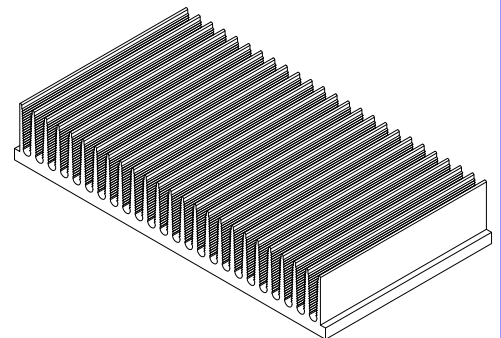
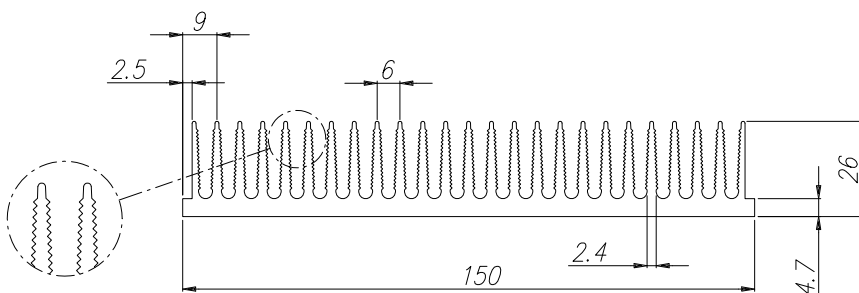

ATECNAL  
BOLOGNA - ITALY



KE150

Peso Kg/m  
Weight Kg/m

6.50

Rt °C/W 0.62

Lung. campione mm  
Sample length mm

150

A

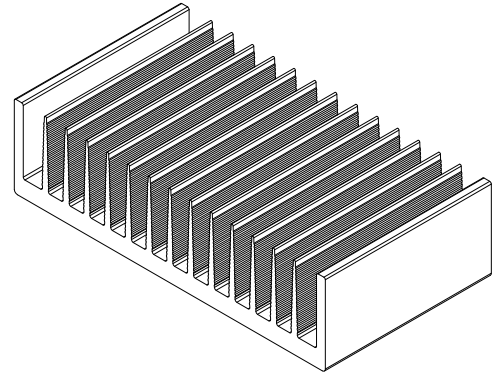
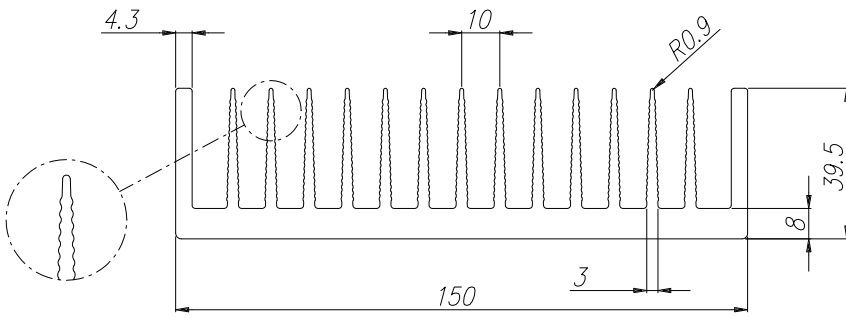

ATECNAL  
BOLOGNA - ITALY

KK150

Peso Kg/m  
Weight Kg/m

5.10

Rt °C/W 0.90

Lung. campione mm  
Sample length mm

150

B

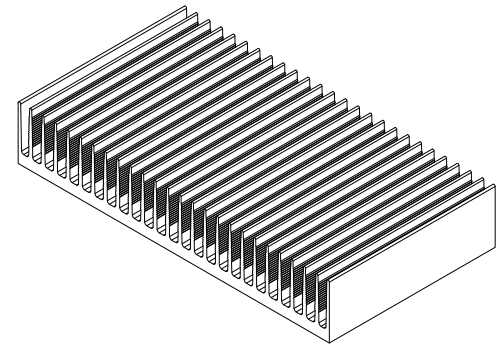
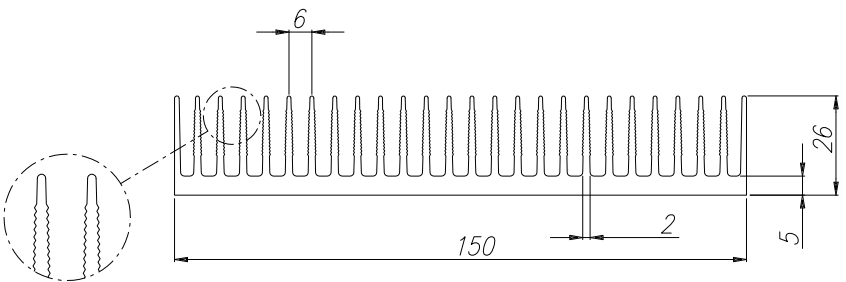

ATECNAL  
BOLOGNA - ITALY

KXH150

Peso Kg/m  
Weight Kg/m

24.1

Rt °C/W 0.30

Lung. campione mm  
Sample length mm

200

C

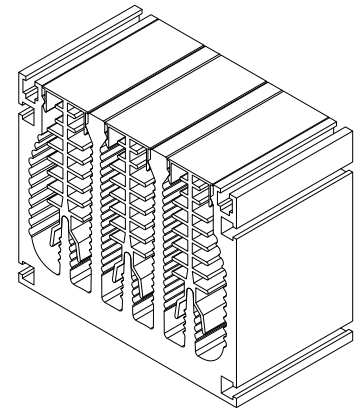
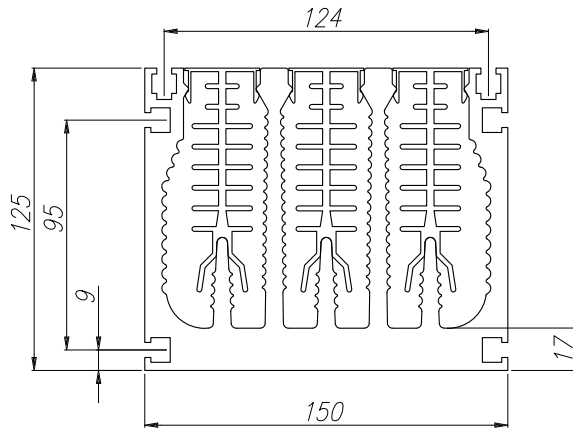

ATECNAL  
BOLOGNA - ITALY

KEAH150

Peso Kg/m  
Weight Kg/m

24.1

Rt °C/W 0.30

Lung. campione mm  
Sample length mm

200

D

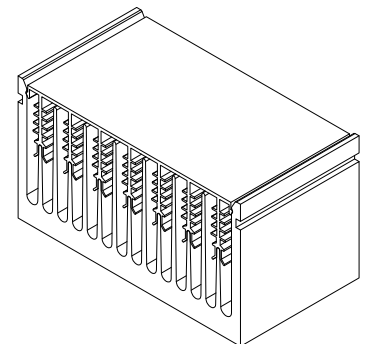
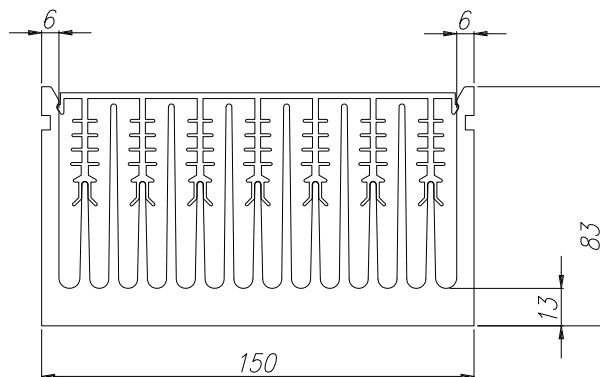

ATECNAL  
BOLOGNA - ITALY

K158

Peso Kg/m  
Weight Kg/m

3.20

Rt °C/W 1.0

Lung. campione mm  
Sample length mm 150

A

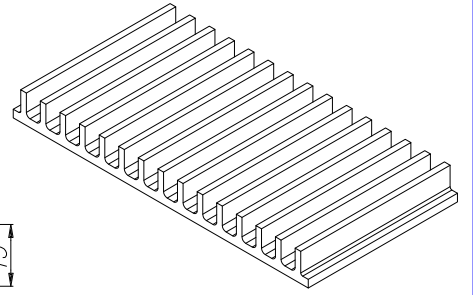
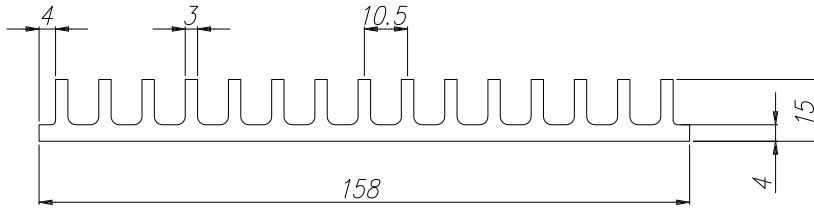

ATECNAL  
BOLOGNA - ITALY

K160

Peso Kg/m  
Weight Kg/m

7.23

Rt °C/W 0.72

Lung. campione mm  
Sample length mm 150

B

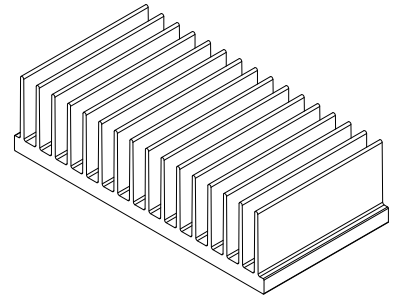
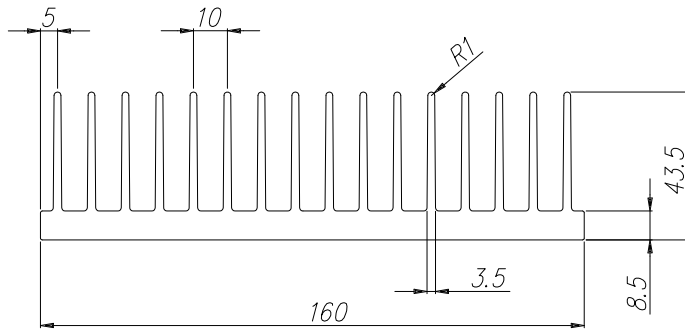

ATECNAL  
BOLOGNA - ITALY

KA160

Peso Kg/m  
Weight Kg/m

7.70

Rt °C/W 0.69

Lung. campione mm  
Sample length mm 150

C

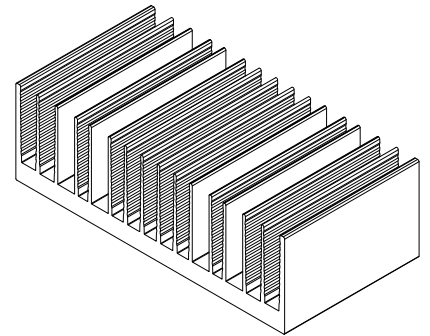
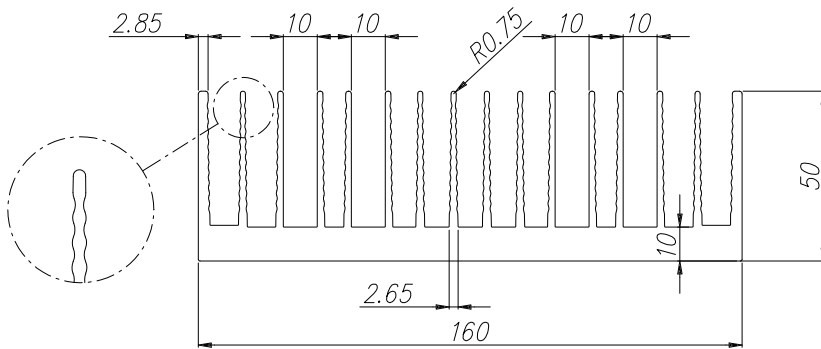

ATECNAL  
BOLOGNA - ITALY

KE160

Peso Kg/m  
Weight Kg/m

7.90

Rt °C/W 0.75

Lung. campione mm  
Sample length mm 150

D

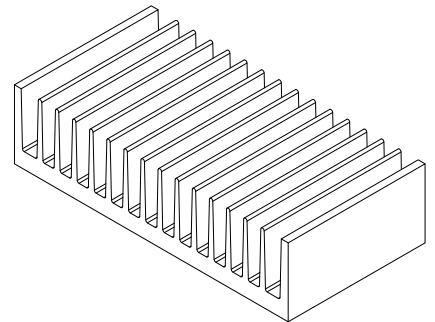
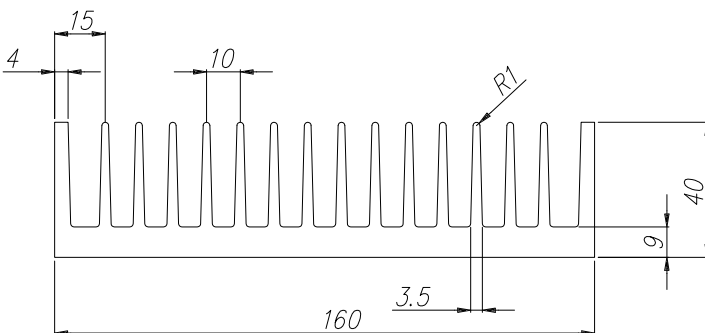

ATECNAL  
BOLOGNA - ITALY

KE160A

Peso Kg/m  
Weight Kg/m

8.10

Rt °C/W

0.76

Lung. campione mm  
Sample length mm

150

A

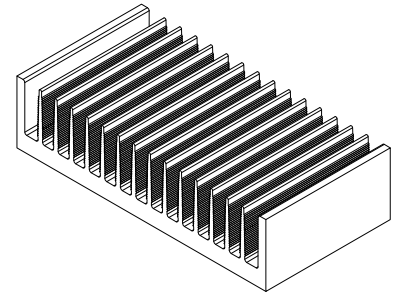
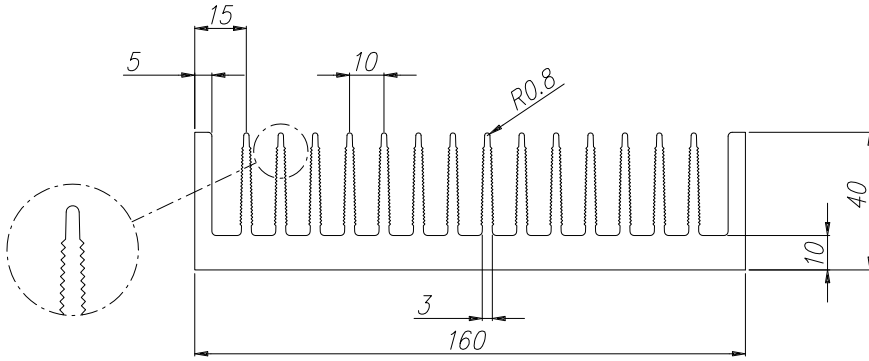

ATECNAL  
BOLOGNA - ITALY

KX160

Peso Kg/m  
Weight Kg/m

6.35

Rt °C/W

0.85

Lung. campione mm  
Sample length mm

150

B

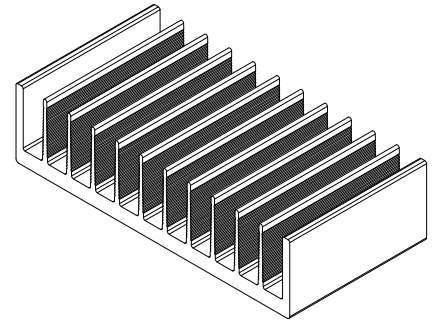
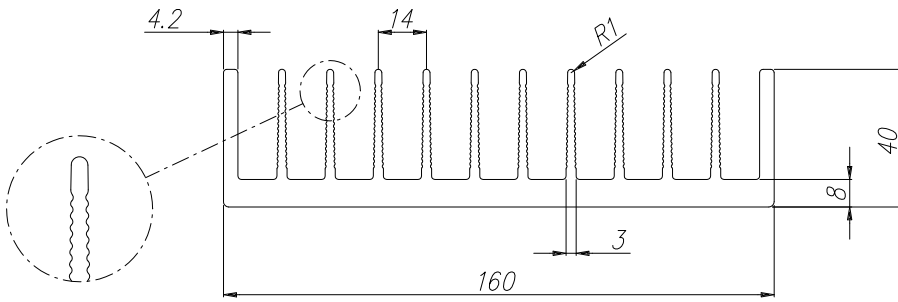

ATECNAL  
BOLOGNA - ITALY

K163

Peso Kg/m  
Weight Kg/m

5.20

Rt °C/W

0.85

Lung. campione mm  
Sample length mm

150

C

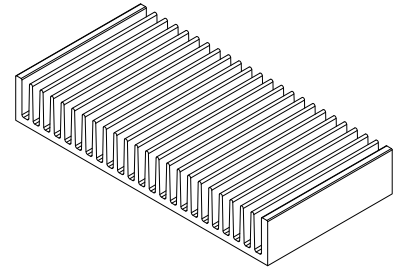
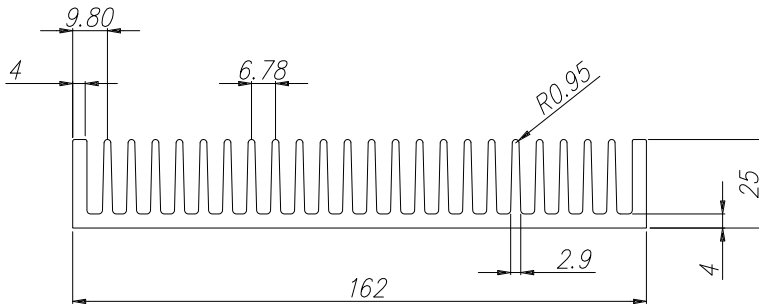

ATECNAL  
BOLOGNA - ITALY

K170

Peso Kg/m  
Weight Kg/m

2.80

Rt °C/W

0.92

Lung. campione mm  
Sample length mm

150

D

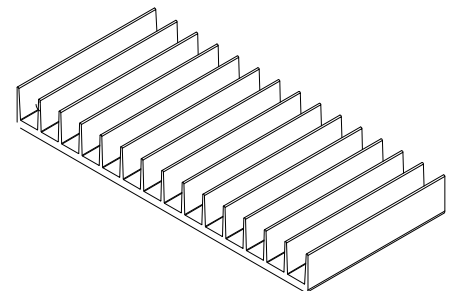
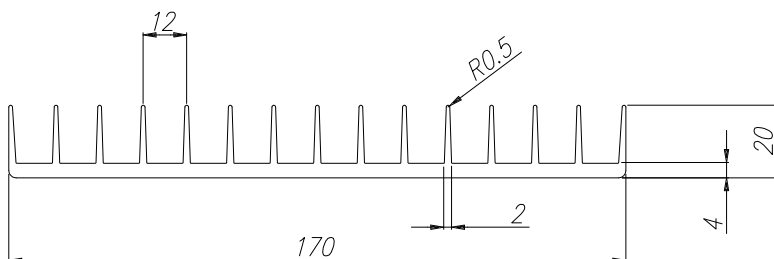

ATECNAL  
BOLOGNA - ITALY

K173

Peso Kg/m  
Weight Kg/m

4.60

Rt °C/W 0.80

Lung. campione mm  
Sample length mm

150

A

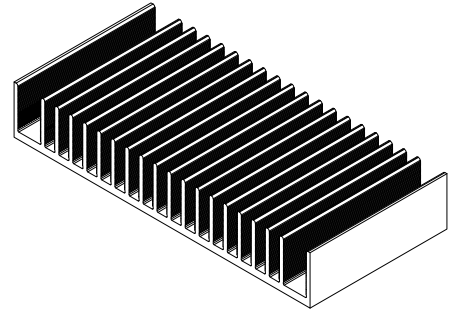
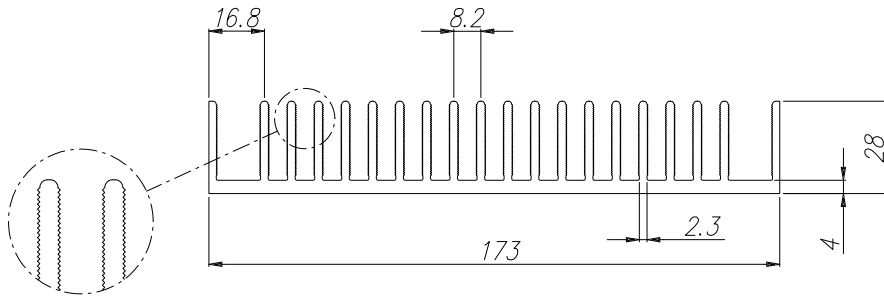

ATECNAL  
BOLOGNA - ITALY

K177

Peso Kg/m  
Weight Kg/m

6.13

Rt °C/W 0.50

Lung. campione mm  
Sample length mm

150

B

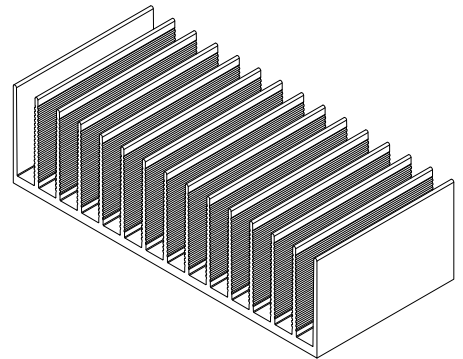
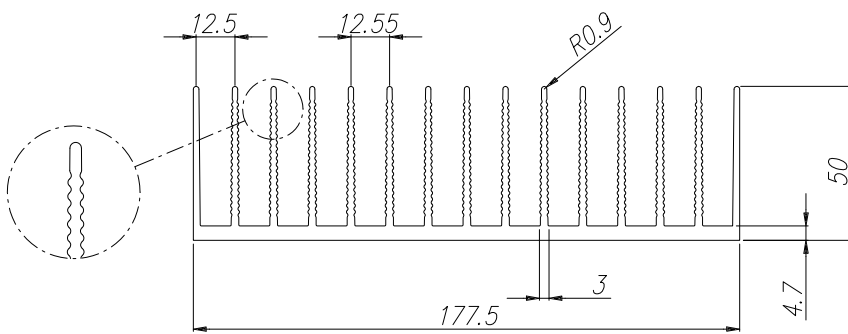

ATECNAL  
BOLOGNA - ITALY

I 100

Peso Kg/m  
Weight Kg/m

17.1

Rt °C/W 0.41

Lung. campione mm  
Sample length mm

150

C

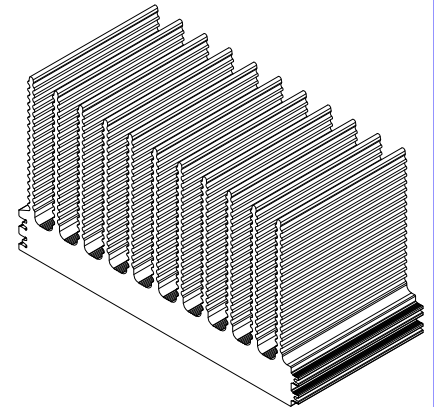
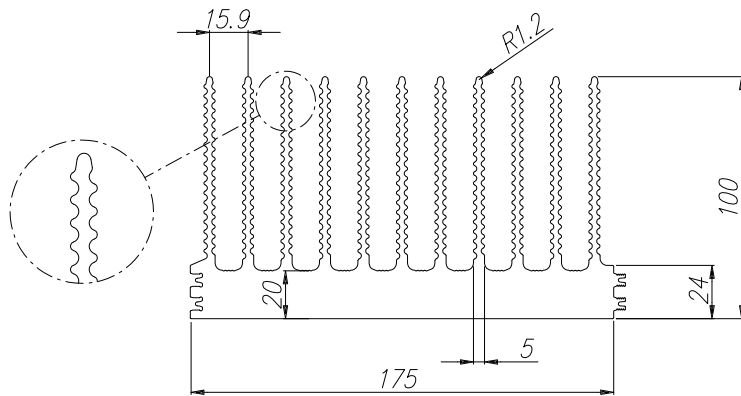

ATECNAL  
BOLOGNA - ITALY

K180

Peso Kg/m  
Weight Kg/m

5.40

Rt °C/W 0.8

Lung. campione mm  
Sample length mm

150

D

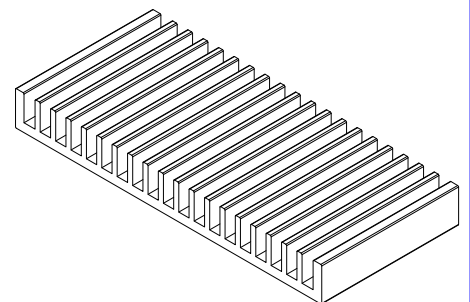
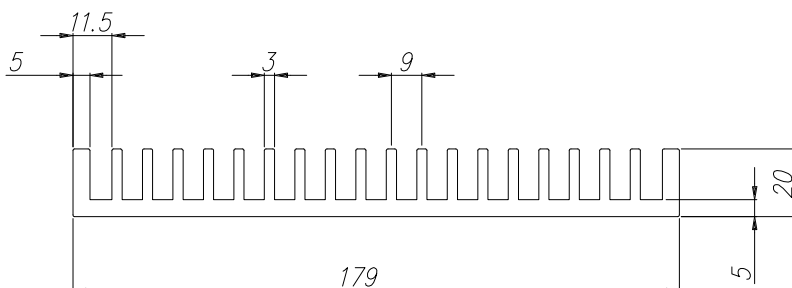

ATECNAL  
BOLOGNA - ITALY

K188

Peso Kg/m  
Weight Kg/m

7.34

Rt °C/W

0.55

Lung. campione mm  
Sample length mm

150

A

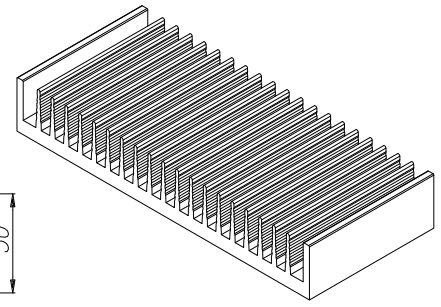
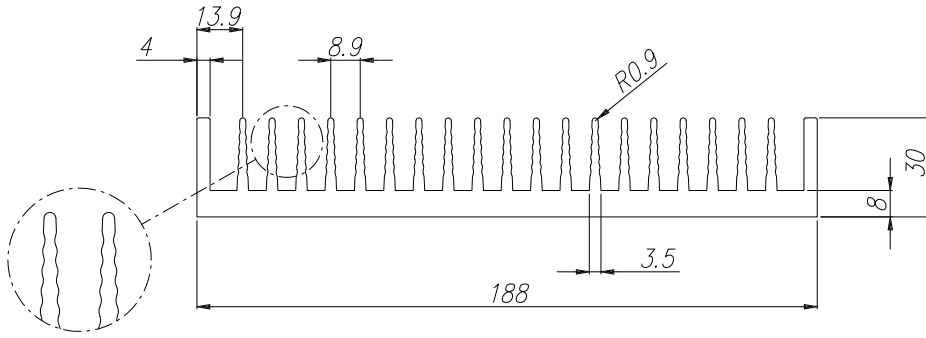

ATECNAL  
BOLOGNA - ITALY

K190

Peso Kg/m  
Weight Kg/m

6.90

Rt °C/W

0.42

Lung. campione mm  
Sample length mm

150

B

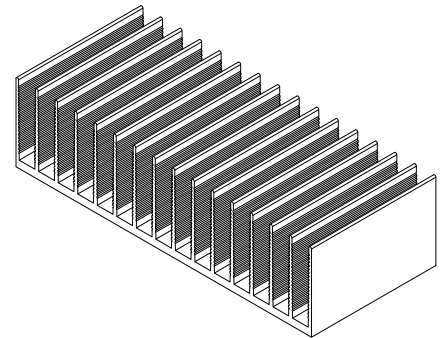
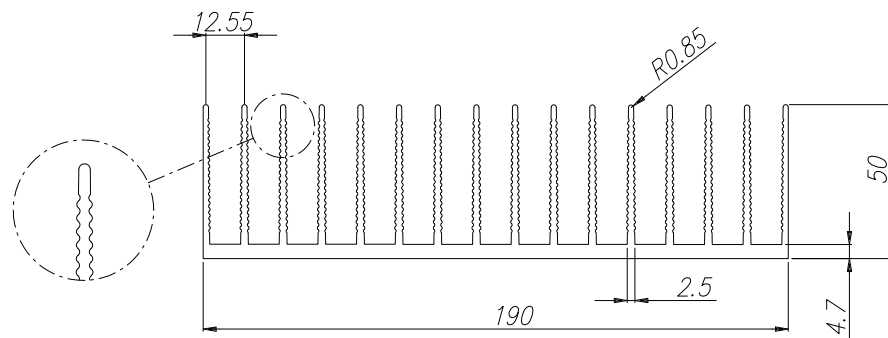

ATECNAL  
BOLOGNA - ITALY

KE190

Peso Kg/m  
Weight Kg/m

16.10

Rt °C/W

0.36

Lung. campione mm  
Sample length mm

150

C

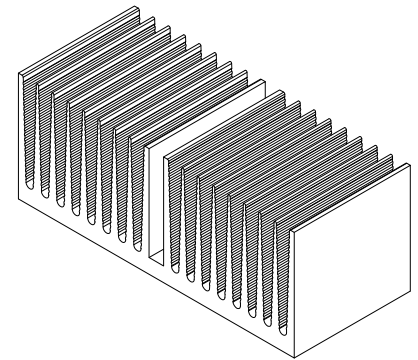
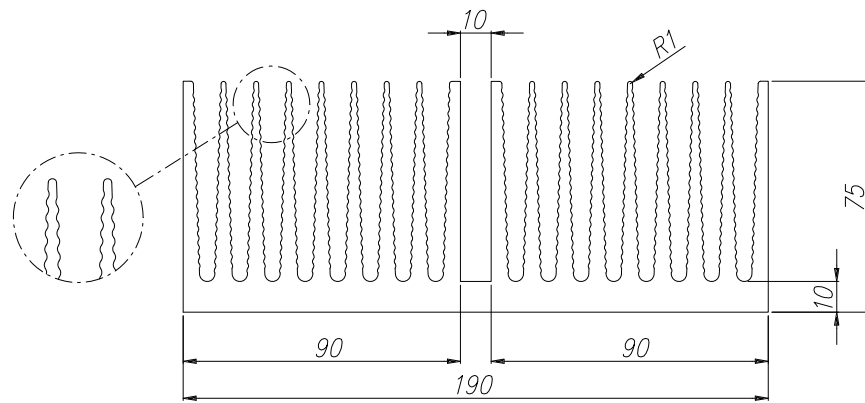

ATECNAL  
BOLOGNA - ITALY

K197

Peso Kg/m  
Weight Kg/m

5.80

Rt °C/W

0.75

Lung. campione mm  
Sample length mm

150

D

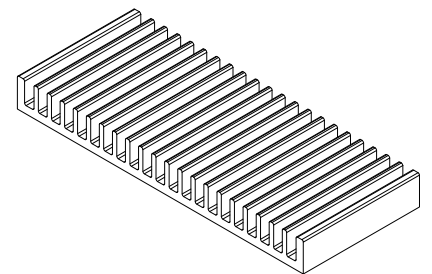
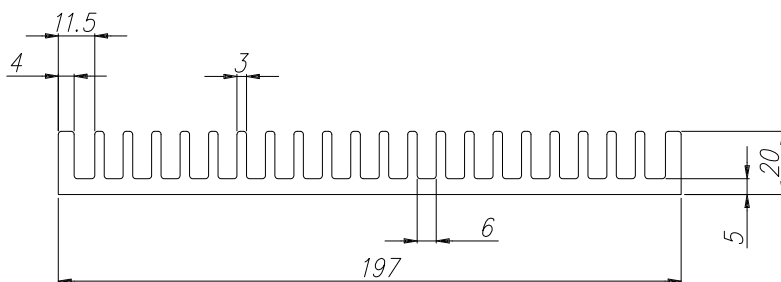

ATECNAL  
BOLOGNA - ITALY

KE197

Peso Kg/m  
Weight Kg/m

5.80

Rt °C/W

0.75

Lung. campione mm  
Sample length mm

150

A

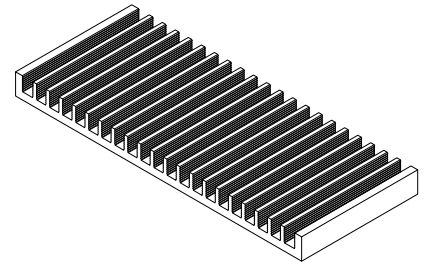
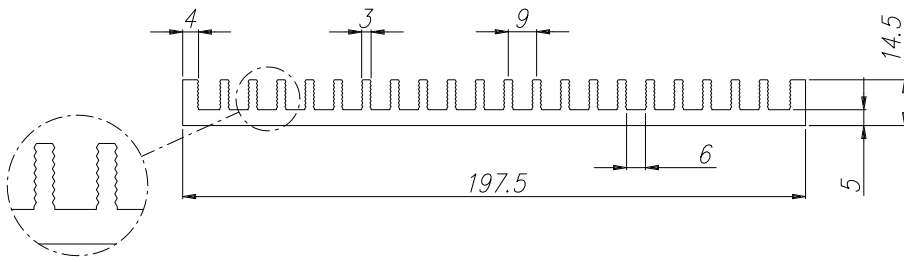

ATECNAL  
BOLOGNA - ITALY

K200

Peso Kg/m  
Weight Kg/m

8.20

Rt °C/W

0.50

Lung. campione mm  
Sample length mm

150

B

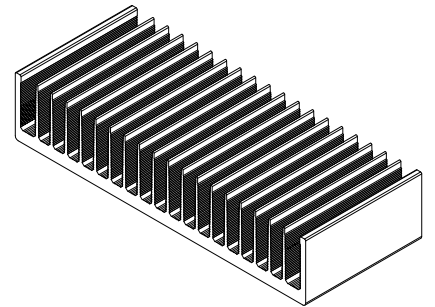
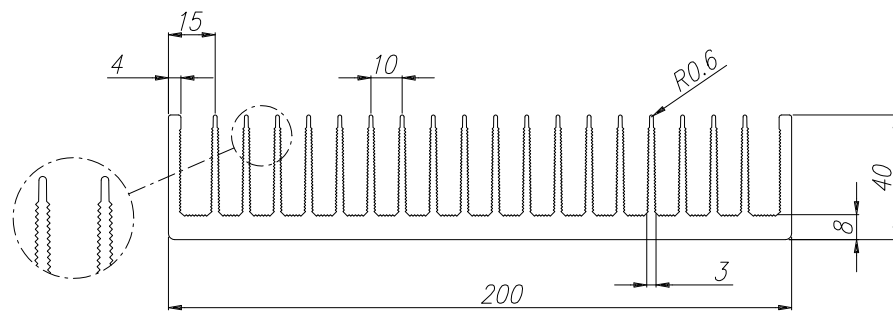

ATECNAL  
BOLOGNA - ITALY

K200B

Peso Kg/m  
Weight Kg/m

8.45

Rt °C/W

0.45

Lung. campione mm  
Sample length mm

150

C

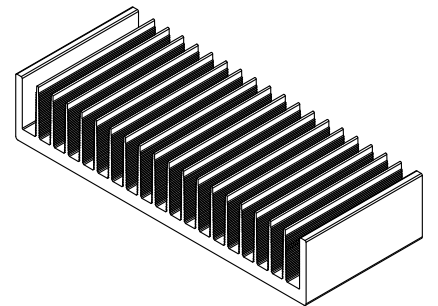
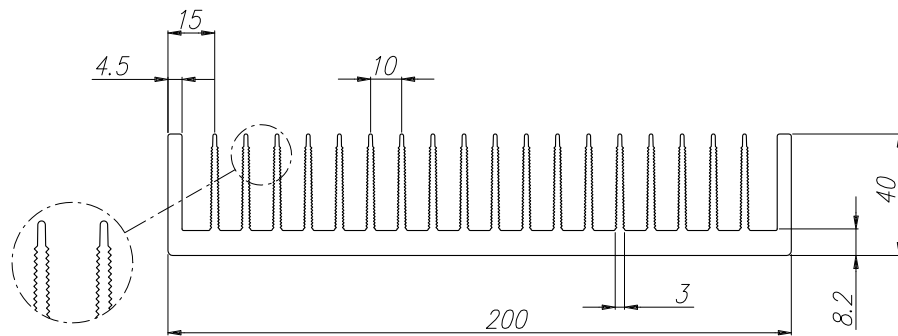

ATECNAL  
BOLOGNA - ITALY

K200C

Peso Kg/m  
Weight Kg/m

8.20

Rt °C/W

0.50

Lung. campione mm  
Sample length mm

150

D

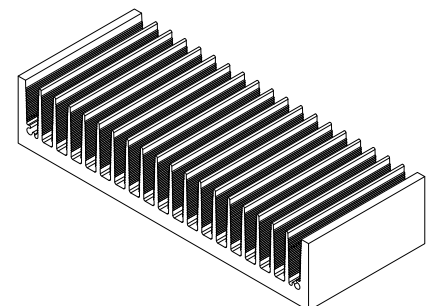
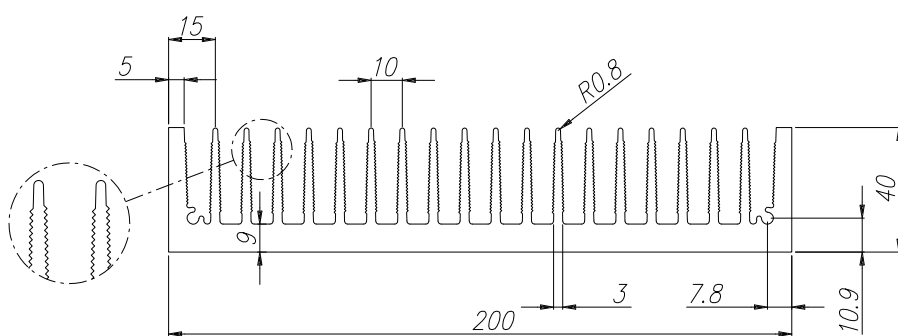

ATECNAL  
BOLOGNA - ITALY

A

**KA200**

Peso Kg/m **19.90**  
Weight Kg/m

Rt °C/W **0.34**

Lung. campione mm **150**  
Sample length mm

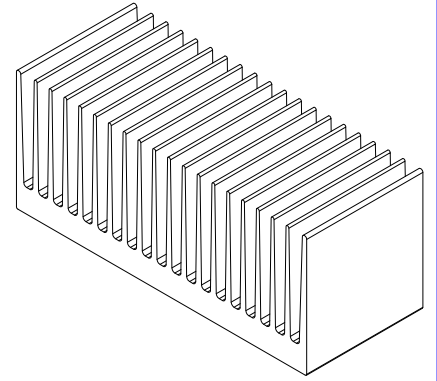
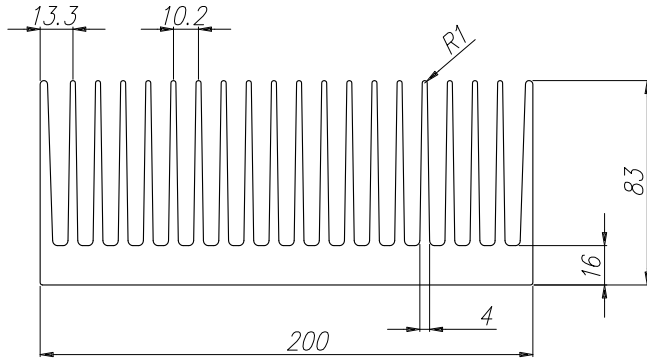

**ATECNAL**  
BOLOGNA - ITALY

B

**KEA200**

Peso Kg/m **8.90**  
Weight Kg/m

Rt °C/W **0.36**

Lung. campione mm **150**  
Sample length mm

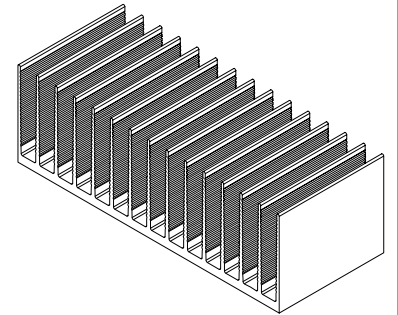
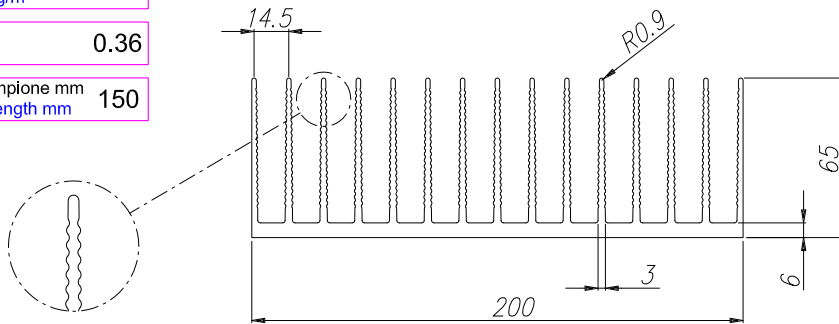

**ATECNAL**  
BOLOGNA - ITALY

C

**KEAH200**

Peso Kg/m **5.50**  
Weight Kg/m

Rt °C/W **0.64**

Lung. campione mm **150**  
Sample length mm

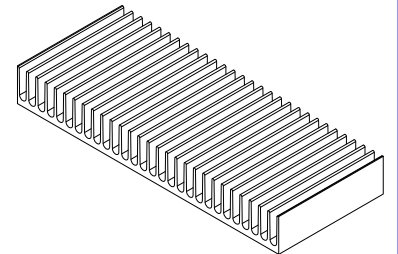
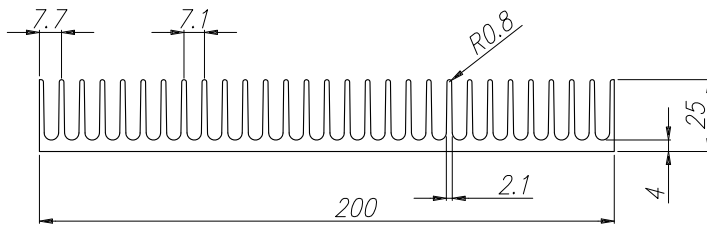

**ATECNAL**  
BOLOGNA - ITALY

D

**KE200**

Peso Kg/m **15.00**  
Weight Kg/m

Rt °C/W **0.39**

Lung. campione mm **150**  
Sample length mm

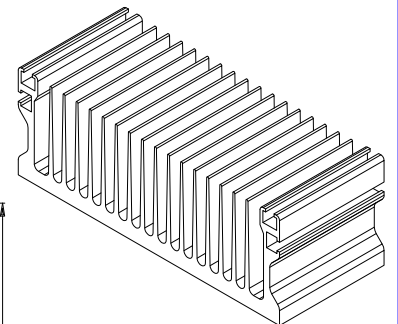
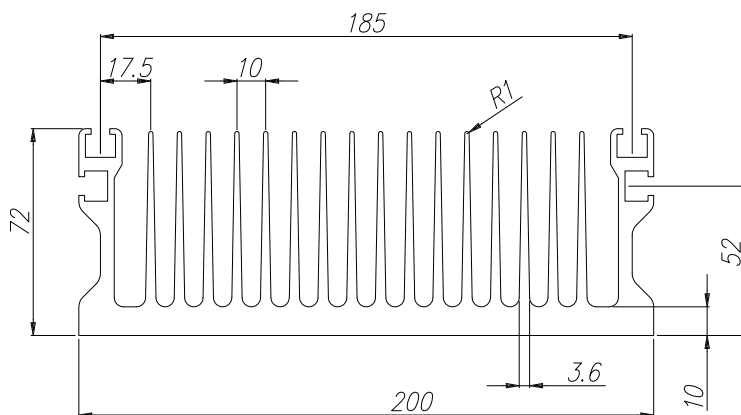

**ATECNAL**  
BOLOGNA - ITALY

KEI200

Peso Kg/m  
Weight Kg/m

2.84

Rt °C/W 1.6

Lung. campione mm  
Sample length mm 150

A

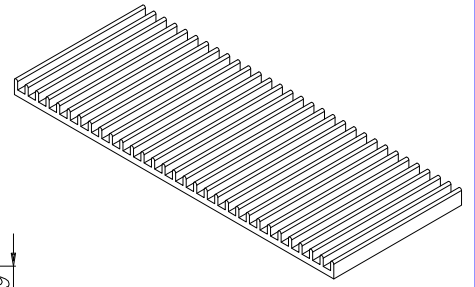
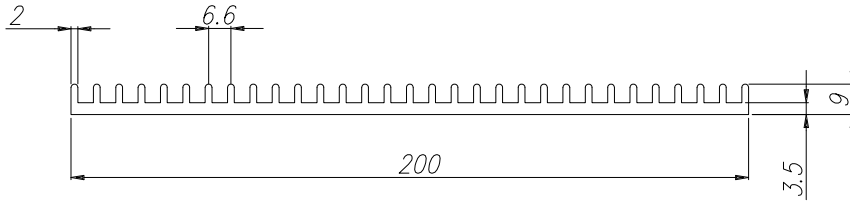

ATECNAL  
BOLOGNA - ITALY

KK200

Peso Kg/m  
Weight Kg/m

4.00

Rt °C/W 0.85

Lung. campione mm  
Sample length mm 150

B

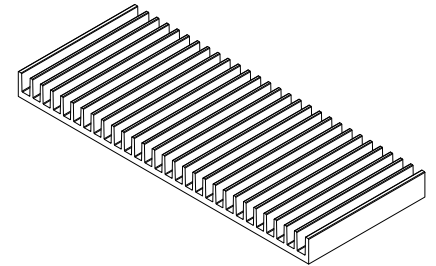
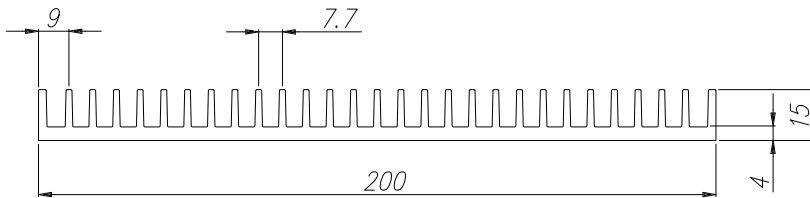

ATECNAL  
BOLOGNA - ITALY

KEIA200

Peso Kg/m  
Weight Kg/m 15.60

Rt °C/W 0.39

Lung. campione mm  
Sample length mm 150

C

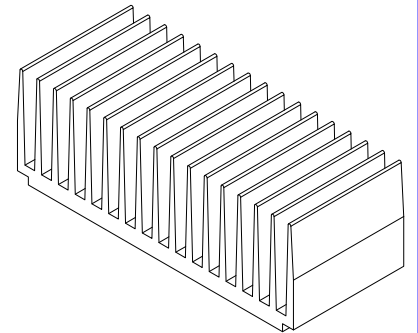
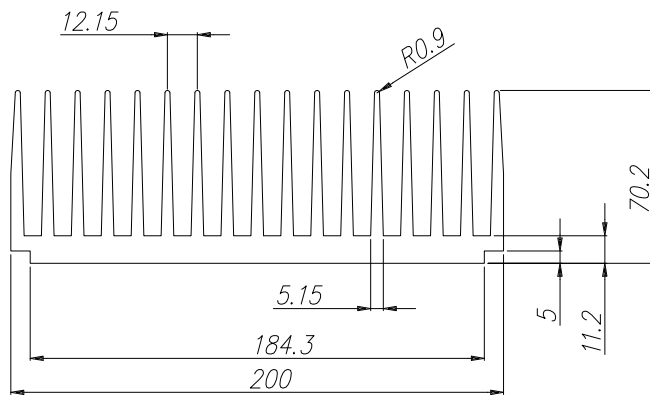

ATECNAL  
BOLOGNA - ITALY

KH200

Peso Kg/m  
Weight Kg/m 17.70

Rt °C/W 0.31

Lung. campione mm  
Sample length mm 150

D

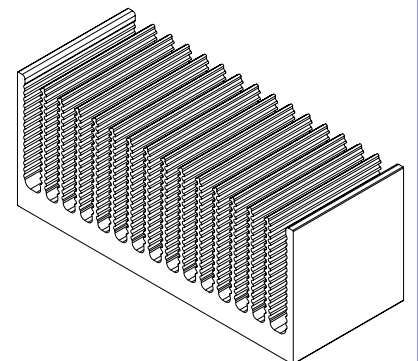
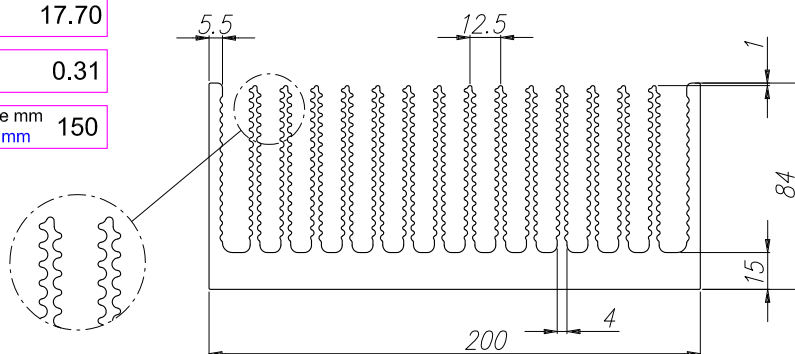

ATECNAL  
BOLOGNA - ITALY



A

**KS200**

Peso Kg/m  
Weight Kg/m 15.00

Rt °C/W 0.35

Lung. campione mm  
Sample length mm 150

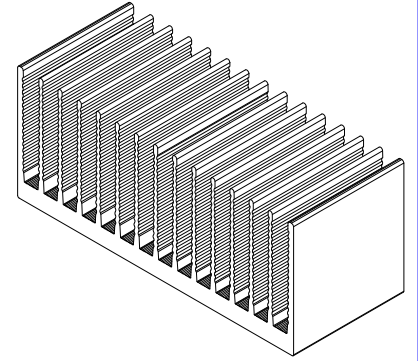
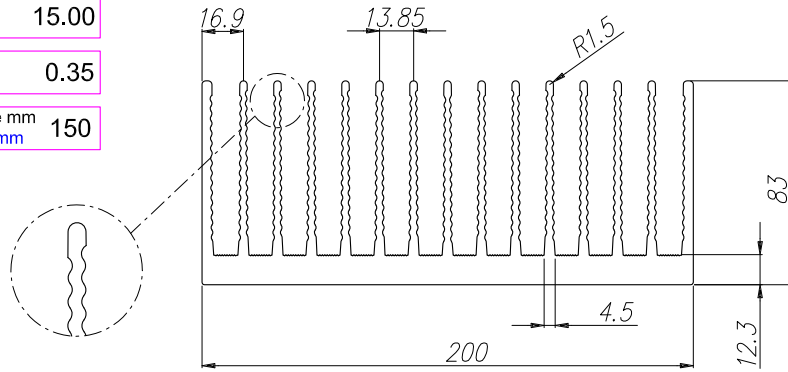

ATECNAL  
BOLOGNA - ITALY

B

**KX200**

Peso Kg/m  
Weight Kg/m 17.40

Rt °C/W 0.32

Lung. campione mm  
Sample length mm 150

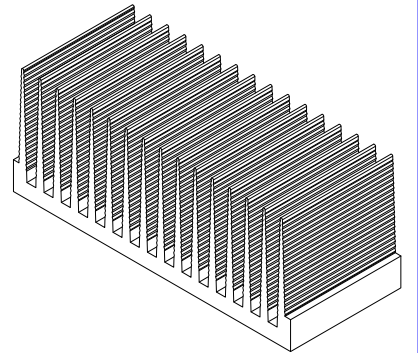
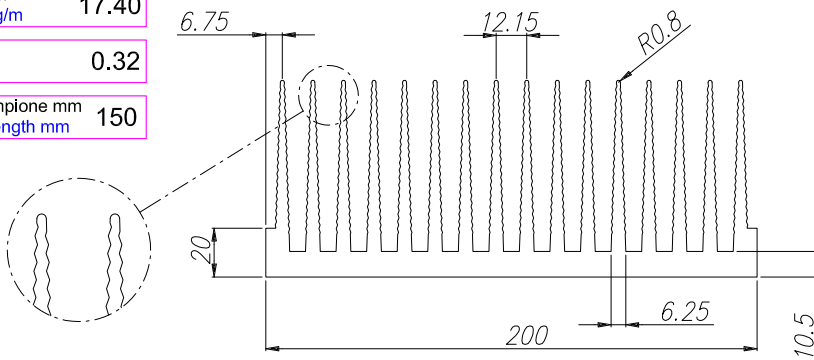

ATECNAL  
BOLOGNA - ITALY

C

**KXH200**

Peso Kg/m  
Weight Kg/m 31.10

Rt °C/W 0.10

Lung. campione mm  
Sample length mm 300

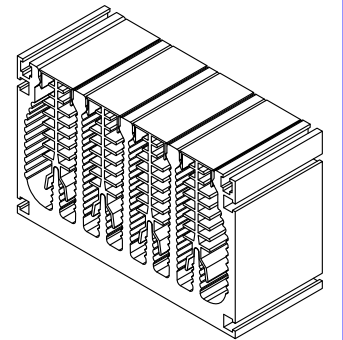
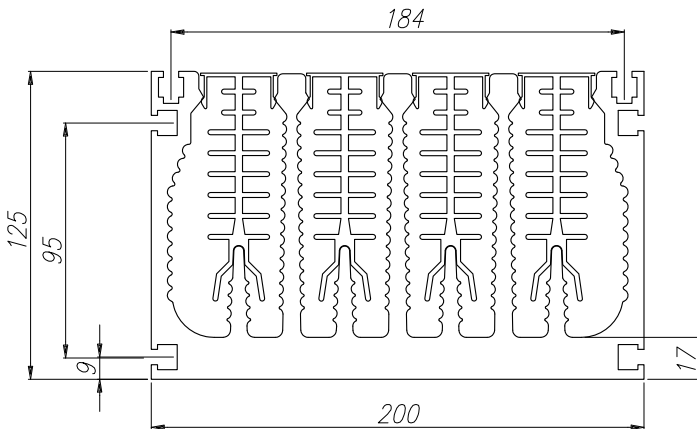

ATECNAL  
BOLOGNA - ITALY

D

**K205**

Peso Kg/m  
Weight Kg/m 20.20

Rt °C/W 0.30

Lung. campione mm  
Sample length mm 300

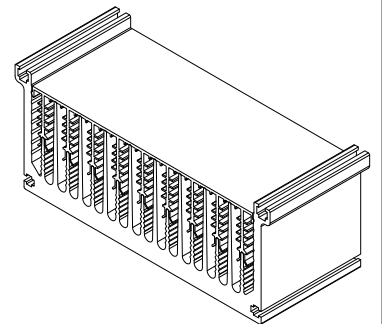
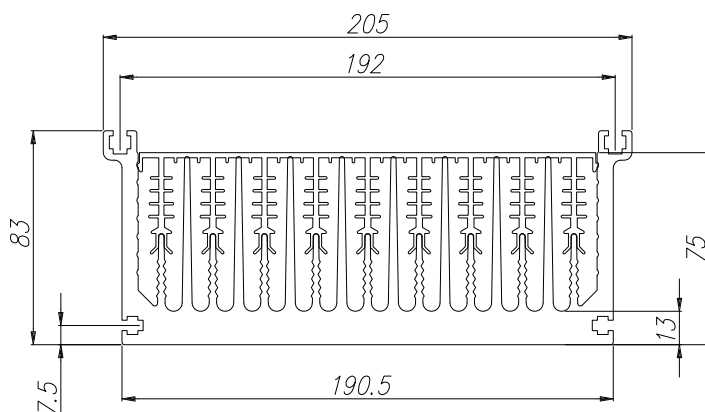

ATECNAL  
BOLOGNA - ITALY

K213

Peso Kg/m  
Weight Kg/m

5.00

Rt °C/W 0.56

Lung. campione mm  
Sample length mm 150

A

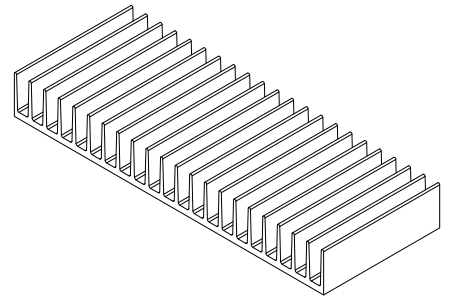
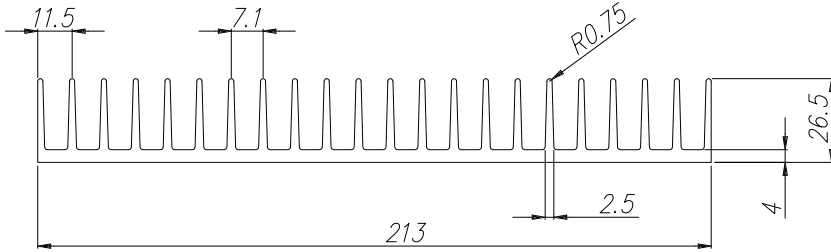

ATECNAL  
BOLOGNA - ITALY

K215

Peso Kg/m  
Weight Kg/m 21.80

Rt °C/W 0.33

Lung. campione mm  
Sample length mm 150

B

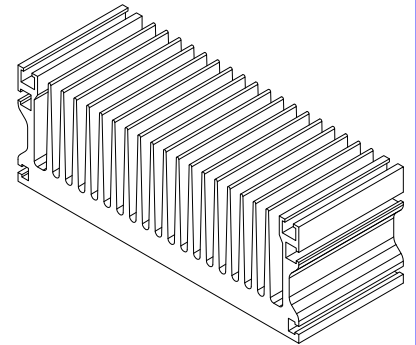
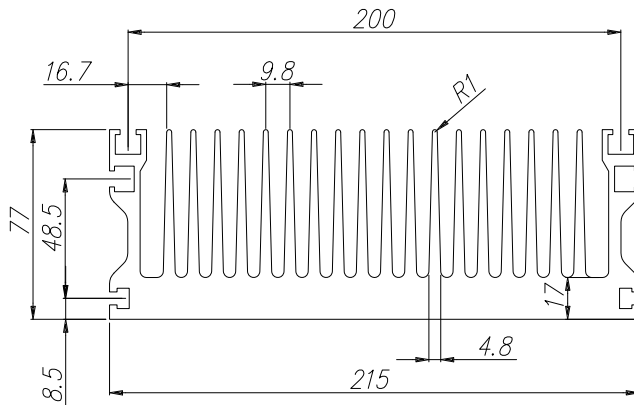

ATECNAL  
BOLOGNA - ITALY

KE215

Peso Kg/m  
Weight Kg/m 20.90

Rt °C/W 0.36

Lung. campione mm  
Sample length mm 150

C

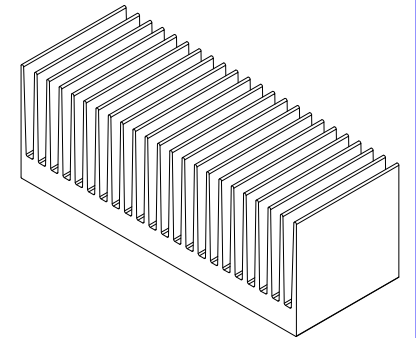
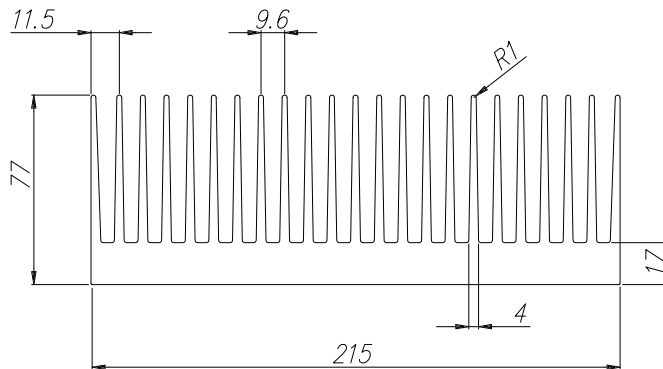

ATECNAL  
BOLOGNA - ITALY

K216

Peso Kg/m  
Weight Kg/m 24.00

Rt °C/W 0.35

Lung. campione mm  
Sample length mm 150

D

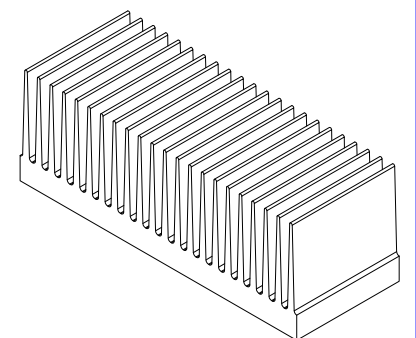
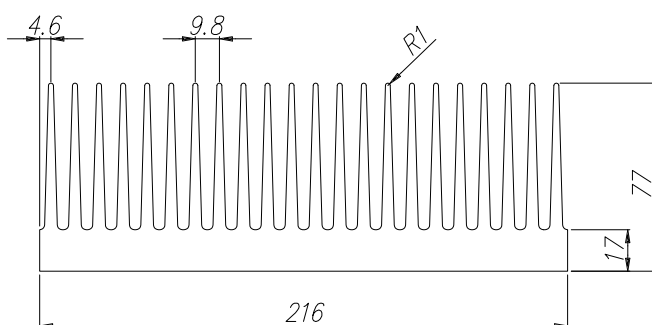

ATECNAL  
BOLOGNA - ITALY

**A**

<b>KX216</b>	
Peso Kg/m Weight Kg/m	18.10
Rt °C/W	0.36
Lung. campione mm Sample length mm	150

**ATECNAL**  
BOLOGNA - ITALY

**B**

<b>K220</b>	
Peso Kg/m Weight Kg/m	18.80
Rt °C/W	0.28
Lung. campione mm Sample length mm	150

**ATECNAL**  
BOLOGNA - ITALY

**C**

<b>K222</b>	Peso Kg/m Weight Kg/m	16.40	Rt °C/W	--	Lung. campione mm Sample length mm	150
-------------	--------------------------	-------	---------	----	---------------------------------------	-----

**ATECNAL**  
BOLOGNA - ITALY

**D**

<b>K224</b>	Peso Kg/m Weight Kg/m	6.70	Rt °C/W	0.44	Lung. campione mm Sample length mm	150
-------------	--------------------------	------	---------	------	---------------------------------------	-----

**ATECNAL**  
BOLOGNA - ITALY

**KE224**

Peso Kg/m  
Weight Kg/m

5.80

Rt °C/W 0.75

Lung. campione mm  
Sample length mm 150

A

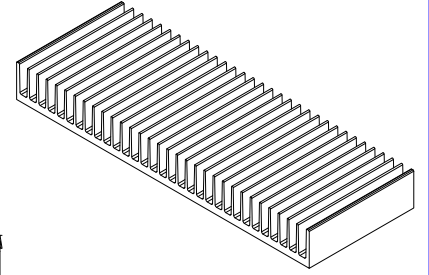
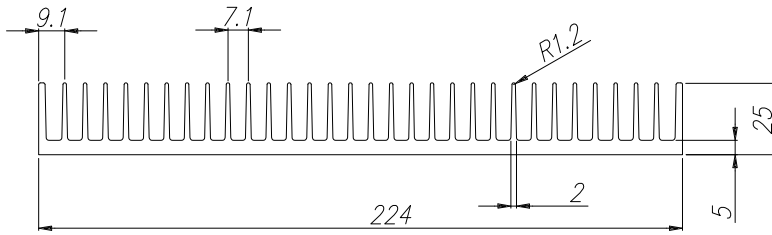

ATECNAL  
BOLOGNA - ITALY

**K230**

Peso Kg/m  
Weight Kg/m 17.30

Rt °C/W 0.30

Lung. campione mm  
Sample length mm 150

B

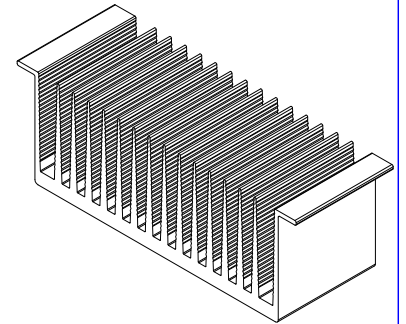
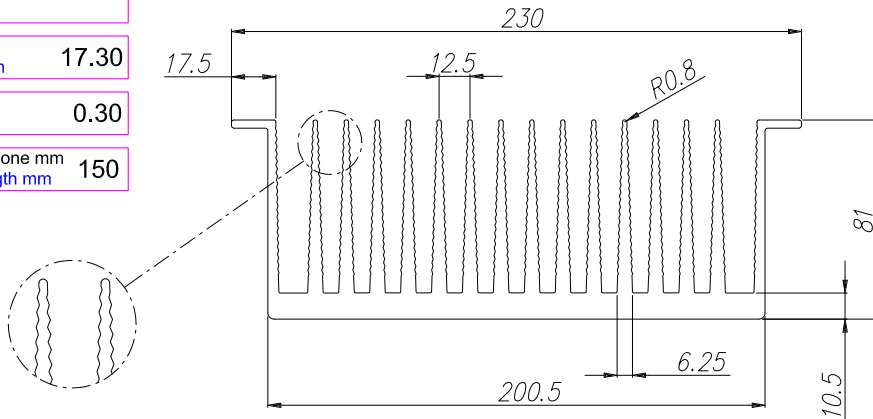

ATECNAL  
BOLOGNA - ITALY

**K235**

Peso Kg/m  
Weight Kg/m 15.20

Rt °C/W 0.35

Lung. campione mm  
Sample length mm 150

C

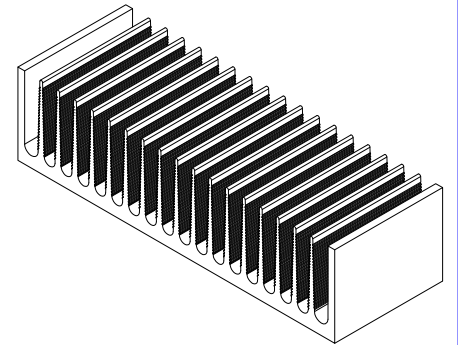
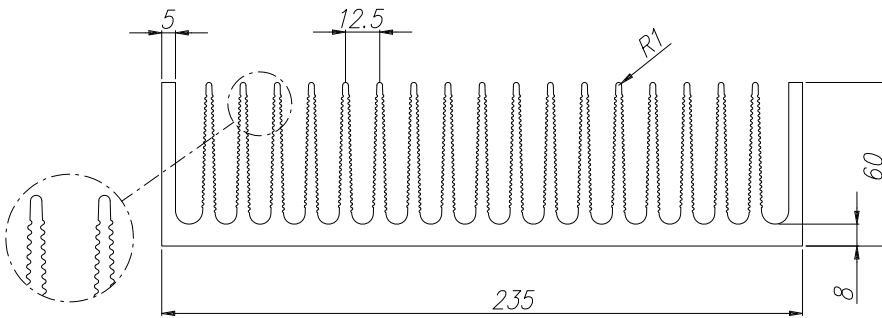

ATECNAL  
BOLOGNA - ITALY

**K245**

Peso Kg/m  
Weight Kg/m 6.60

Rt °C/W 0.43

Lung. campione mm  
Sample length mm 150

D

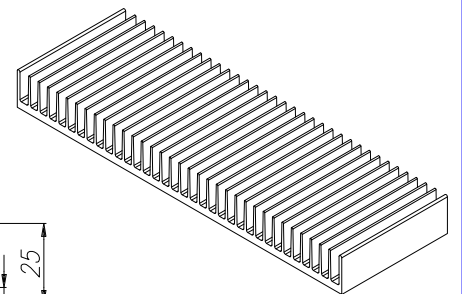
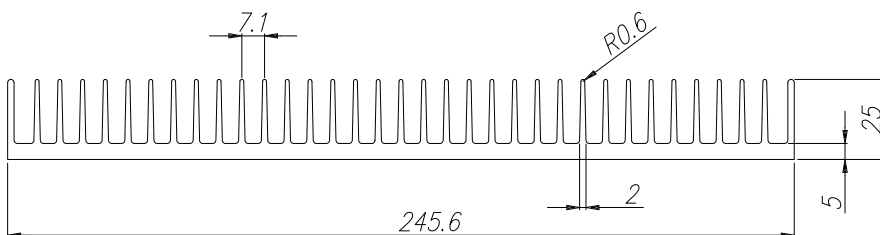

ATECNAL  
BOLOGNA - ITALY

**K250**    **Peso Kg/m**    **11.15**    **Rt °C/W**    **0.40**    **Lung. campione mm**    **150**  
**Weight Kg/m**    **Sample length mm**

A

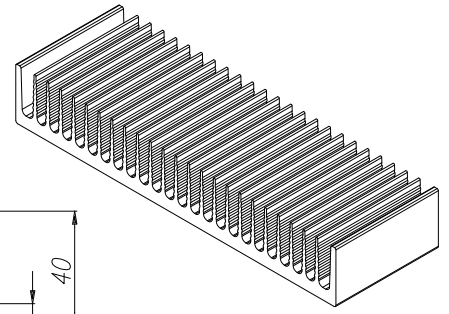
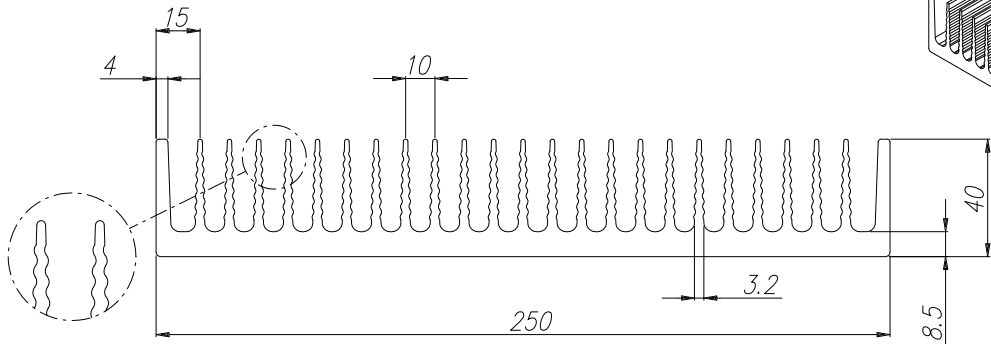

**ATECNAL**  
BOLOGNA - ITALY

**K250E**    **Peso Kg/m**    **12.50**    **Rt °C/W**    **0.41**    **Lung. campione mm**    **150**  
**Weight Kg/m**    **Sample length mm**

B

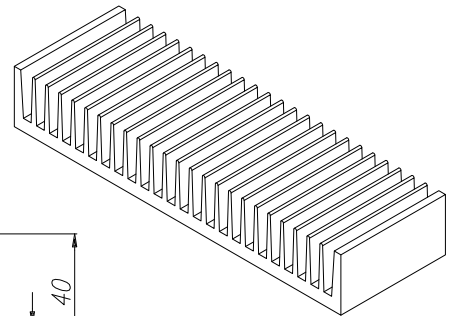
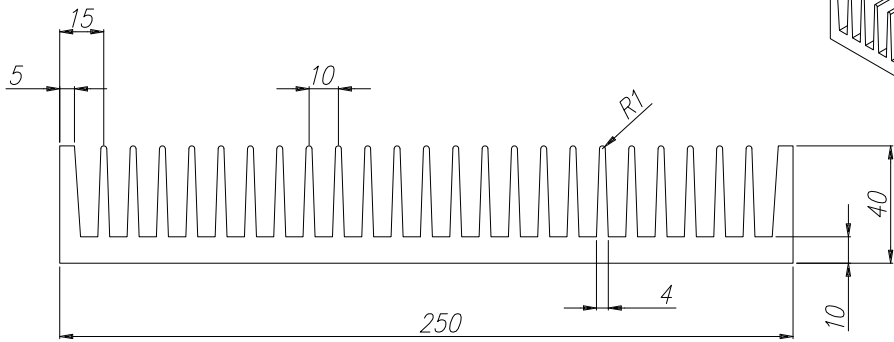

**ATECNAL**  
BOLOGNA - ITALY

**KE250**    **Peso Kg/m**    **15.20**    **Rt °C/W**    **0.35**    **Lung. campione mm**    **150**  
**Weight Kg/m**    **Sample length mm**

C

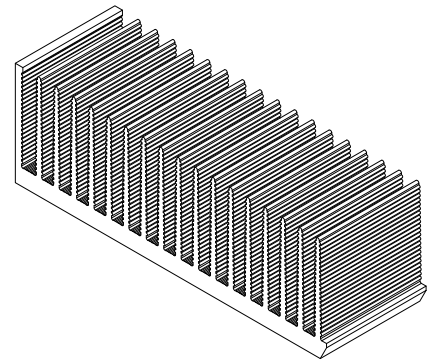
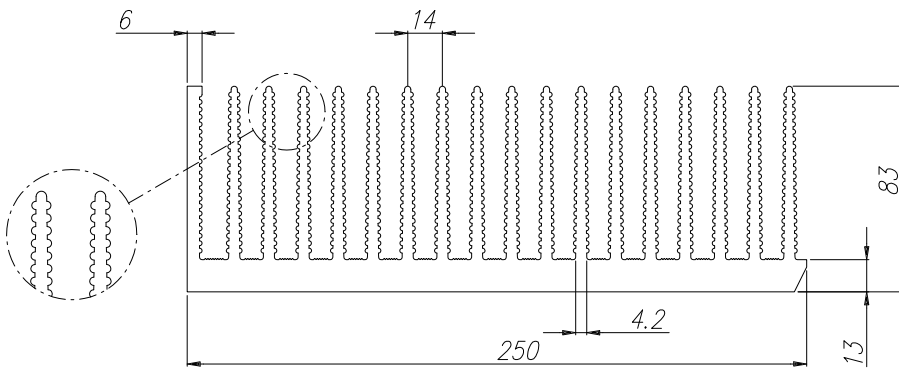

**ATECNAL**  
BOLOGNA - ITALY

**KX250**    **Peso Kg/m**    **25.10**    **Rt °C/W**    **0.25**    **Lung. campione mm**    **150**  
**Weight Kg/m**    **Sample length mm**

D

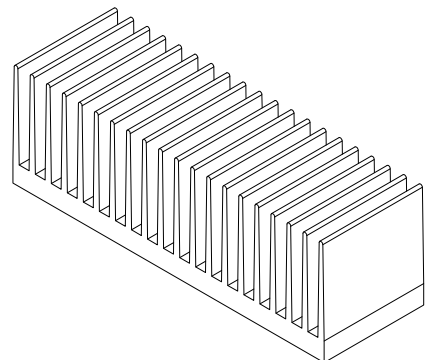
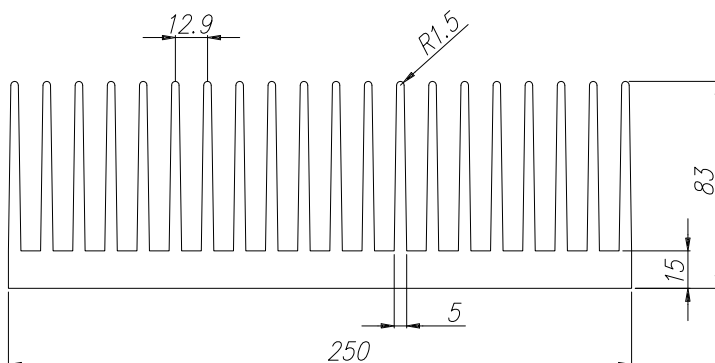

**ATECNAL**  
BOLOGNA - ITALY

**KK250**

Peso Kg/m  
Weight Kg/m

21.40

Rt °C/W 0.24

Lung. campione mm  
Sample length mm 150

A

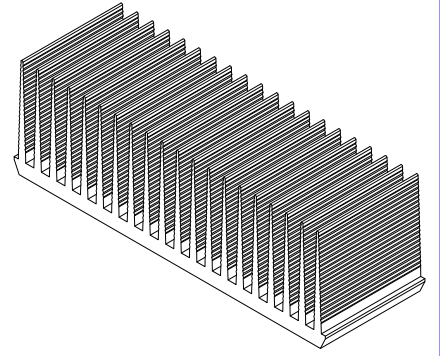
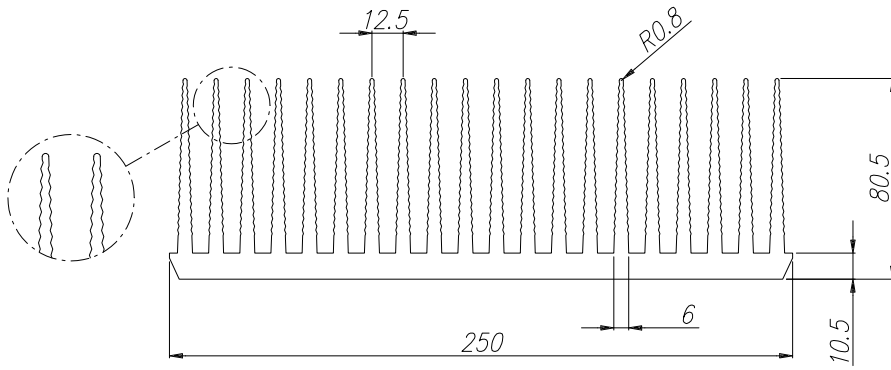

ATECNAL  
BOLOGNA - ITALY

**K260**

Peso Kg/m  
Weight Kg/m

20.65

Rt °C/W --

Lung. campione mm  
Sample length mm 150

B

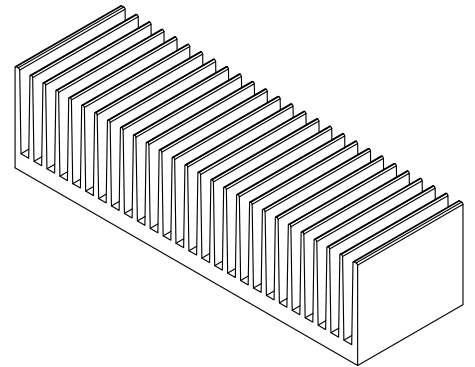
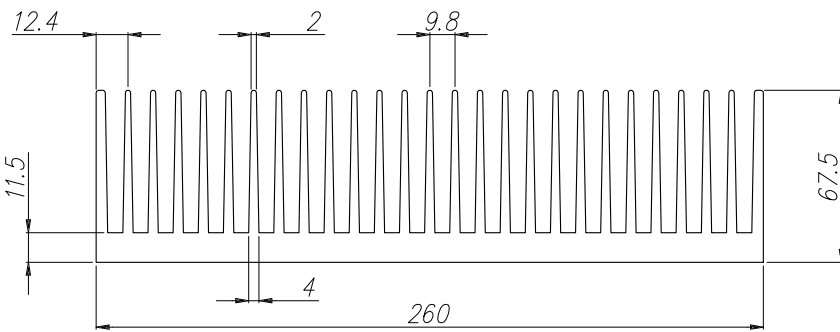

ATECNAL  
BOLOGNA - ITALY

**K300**

Peso Kg/m  
Weight Kg/m

12.80

Rt °C/W 0.32

Lung. campione mm  
Sample length mm 150

C

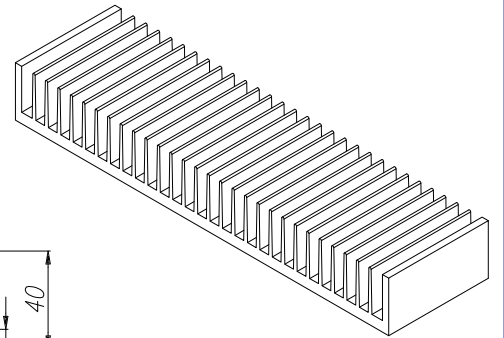
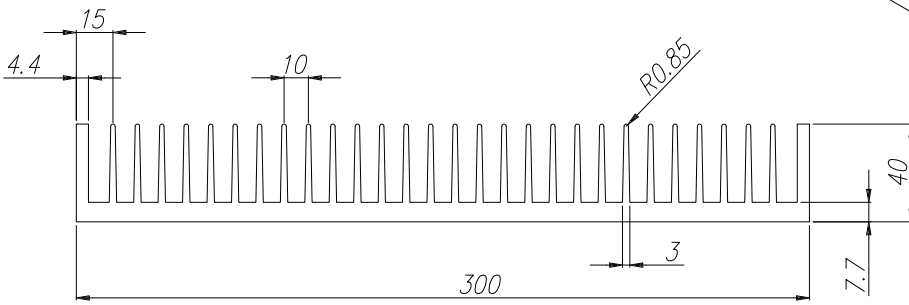

ATECNAL  
BOLOGNA - ITALY

**KE300**

Peso Kg/m  
Weight Kg/m

22.20

Rt °C/W 0.21

Lung. campione mm  
Sample length mm 150

D

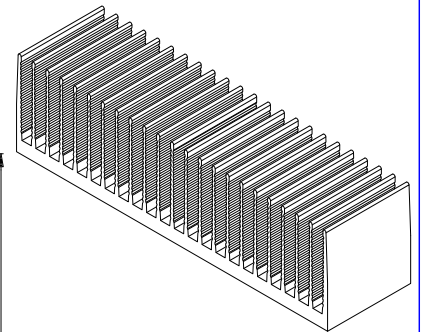
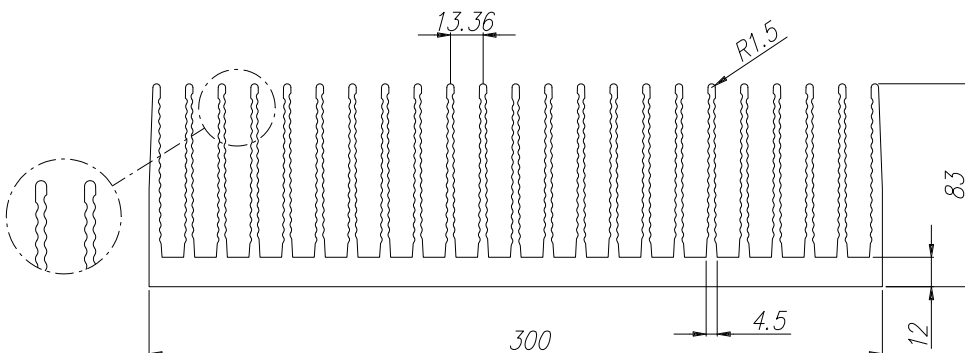

ATECNAL  
BOLOGNA - ITALY

KEA300

Peso Kg/m  
Weight Kg/m

9.10

Rt °C/W

0.44

Lung. campione mm  
Sample length mm

150

A

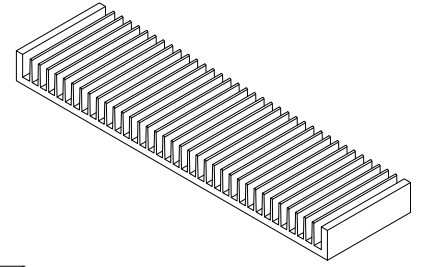
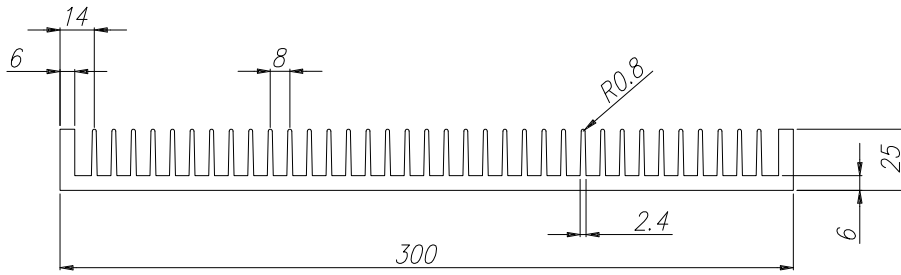

ATECNAL  
BOLOGNA - ITALY

KH300

Peso Kg/m  
Weight Kg/m

26.60

Rt °C/W

0.20

Lung. campione mm  
Sample length mm

150

B

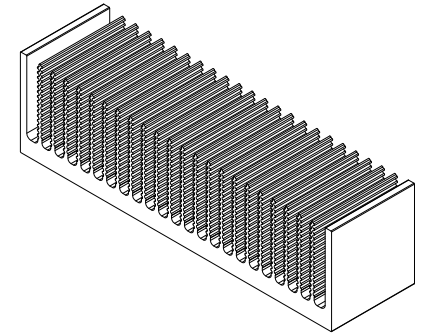
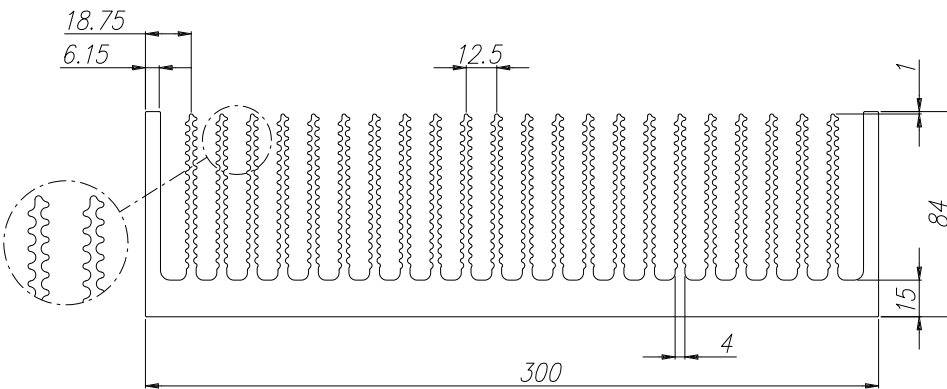

ATECNAL  
BOLOGNA - ITALY

KK300

Peso Kg/m  
Weight Kg/m

15.75

Rt °C/W

0.32

Lung. campione mm  
Sample length mm

150

C

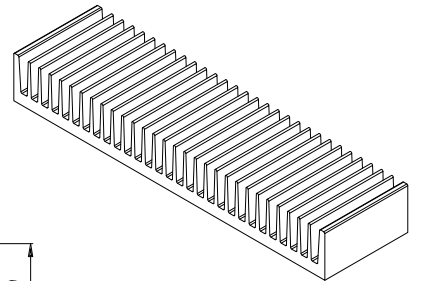
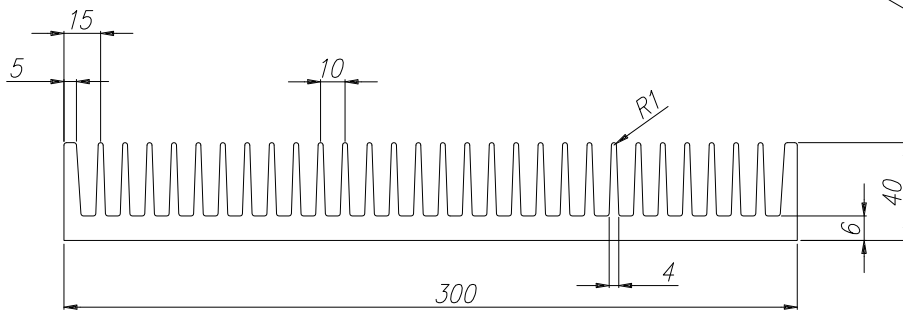

ATECNAL  
BOLOGNA - ITALY

KX300

Peso Kg/m  
Weight Kg/m

28.60

Rt °C/W

0.20

Lung. campione mm  
Sample length mm

150

D

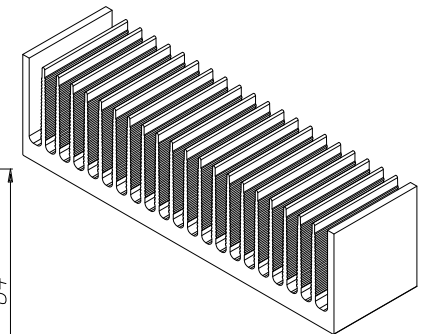
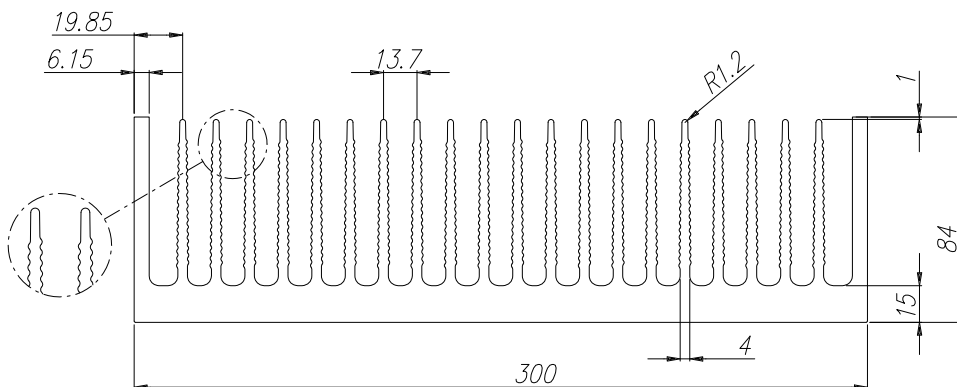

ATECNAL  
BOLOGNA - ITALY

K400

Peso Kg/m  
Weight Kg/m

21.03

Rt °C/W

0.25

Lung. campione mm  
Sample length mm

150

A

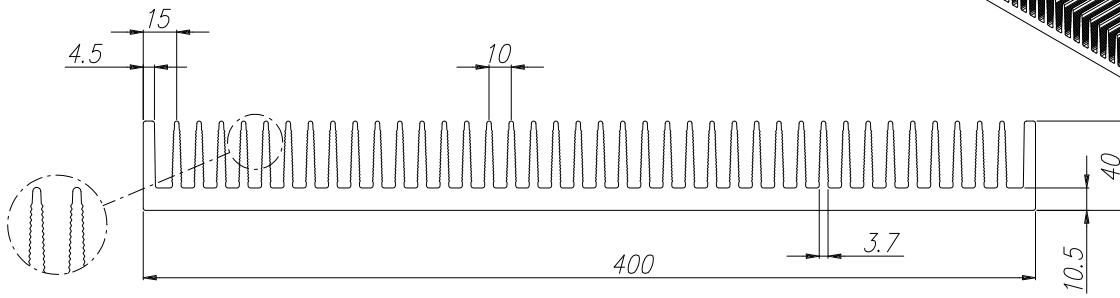

TECNAL  
BOLOGNA - ITALY

K426

Peso Kg/m  
Weight Kg/m

6.80

Rt °C/W

0.90

Lung. campione mm  
Sample length mm

150

B

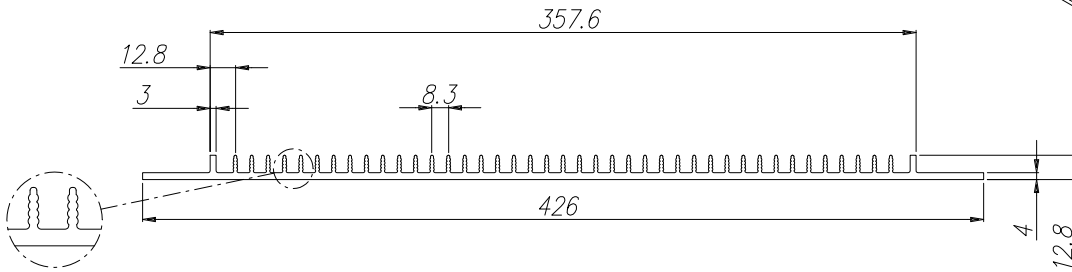

TECNAL  
BOLOGNA - ITALY

C

D



PEZZI SALDATI

UTILIZZO

A causa dei limiti della tecnologia dell' estrusione non è possibile ottenere profili di dimensioni superiori a circa (400x83) mm.  
 Tecnoal propone da oltre un decennio pezzi di dimensioni molto più grandi, ricavandoli tramite saldatura di due o più profili esistenti.  
 I profili di seguito elencati sono stati progettati e ottenuti tramite saldatura, questi presentano caratteristiche meccaniche e termiche simili ad un estruso integrale.  
 E' anche possibile ottenere profili dimensionalmente diversi, utilizzando profili esistenti, o tagliati a dimensioni opportune prima della saldatura.  
 Tale procedimento risulta estremamente flessibile alle esigenze dimensionali del cliente, soprattutto quando i quantitativi risultano modesti per giustificare la creazione di un nuovo estruso.

A

CARATTERISTICHE

KE400

Peso Kg/m  
Weight Kg/m

35.77

Rt °C/W

0.15

Lung. campione mm  
Sample length mm

150

B

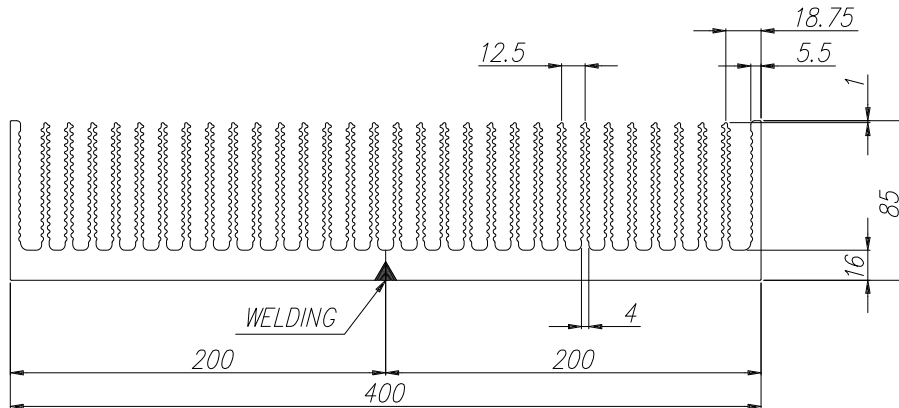

KE444

Peso Kg/m  
Weight Kg/m

--

Rt °C/W

--

Lung. campione mm  
Sample length mm

150

C

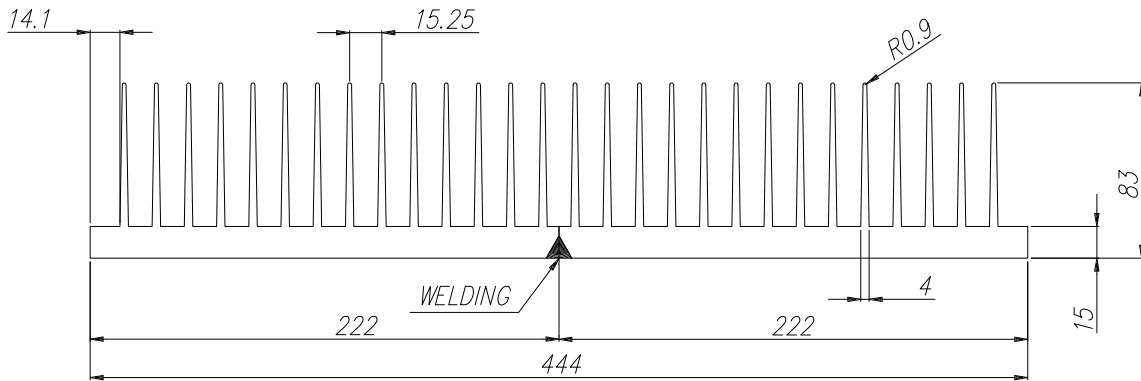

KE450

Peso Kg/m  
Weight Kg/m

40.15

Rt °C/W

--

Lung. campione mm  
Sample length mm

150

D

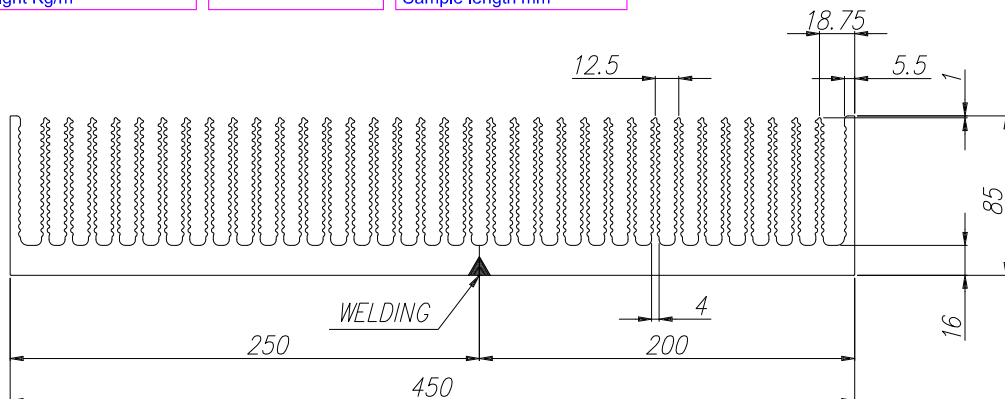

Up on request



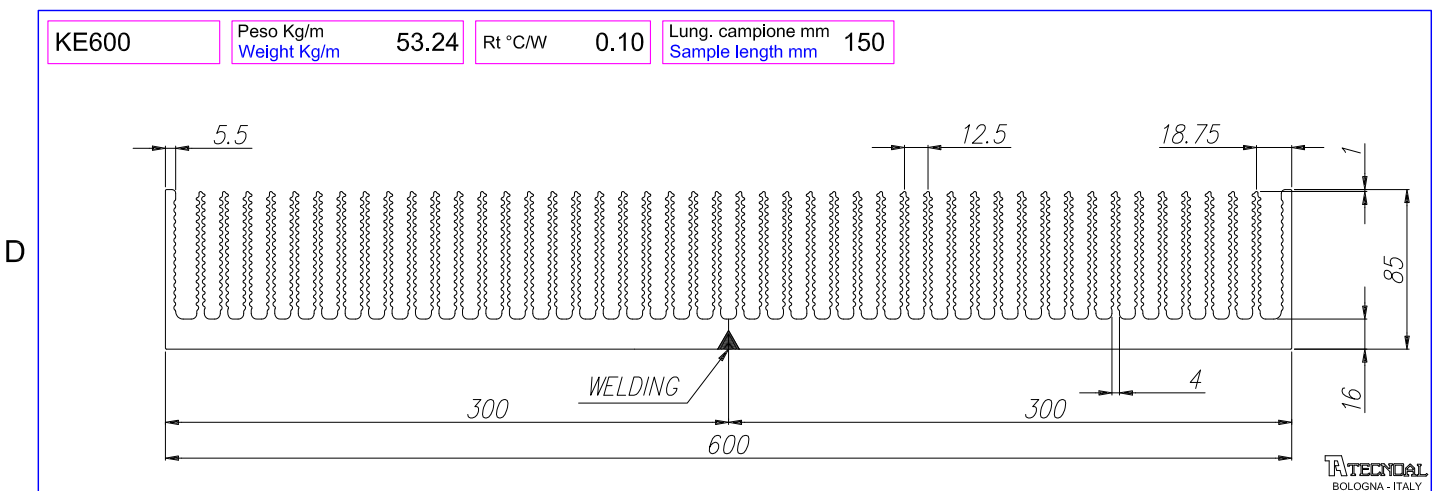
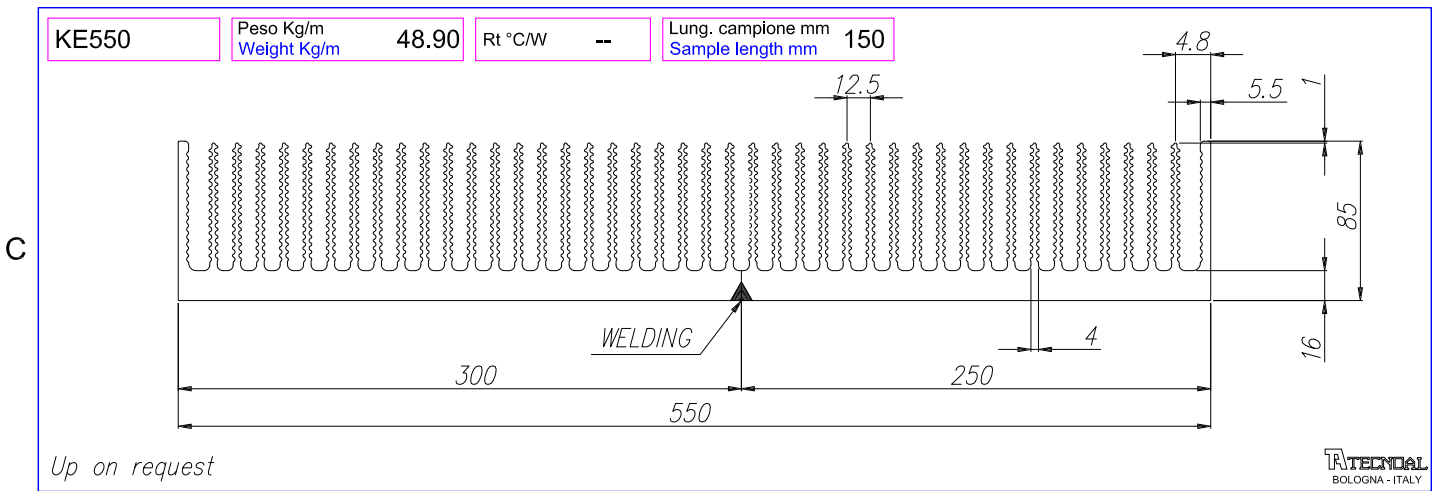
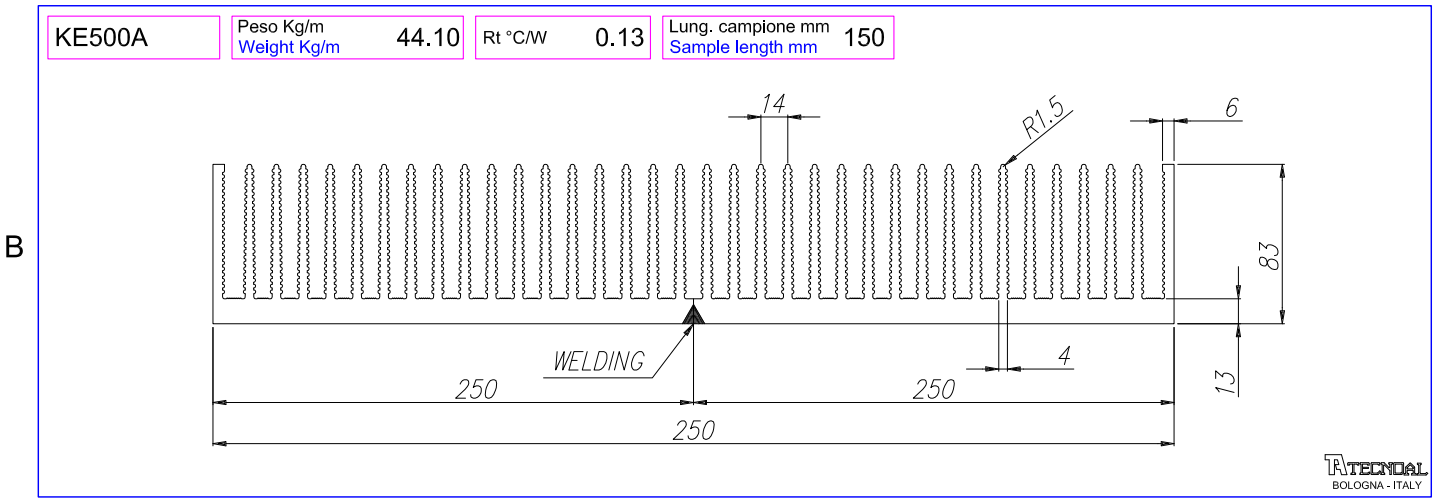
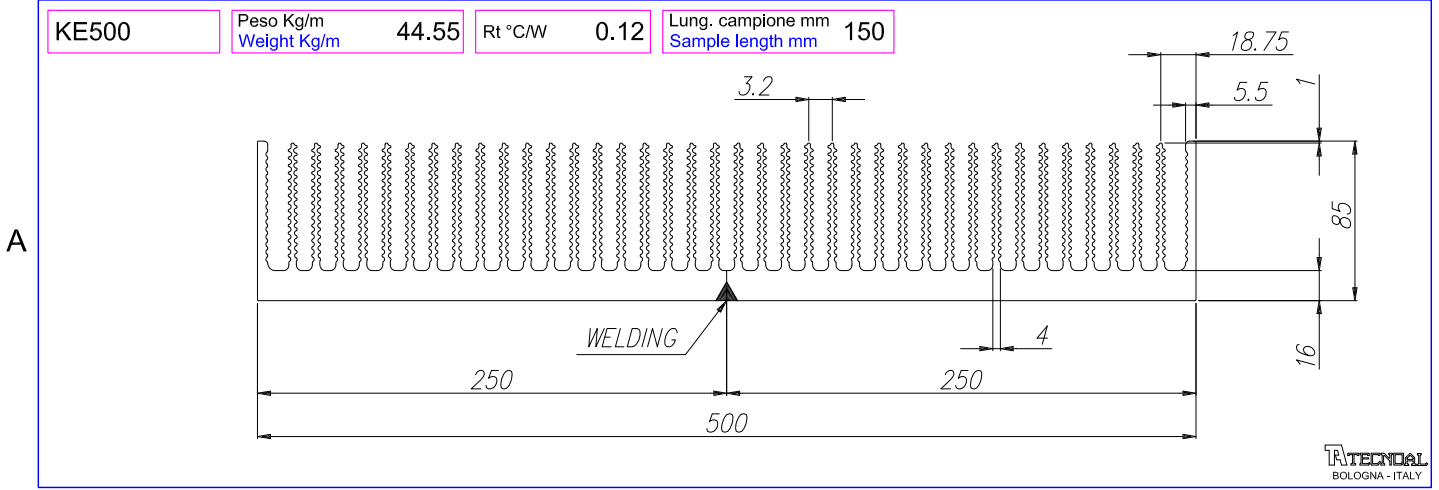

KE650

Peso Kg/m  
Weight Kg/m

57.65

Rt °C/W --

Lung. campione mm  
Sample length mm 150

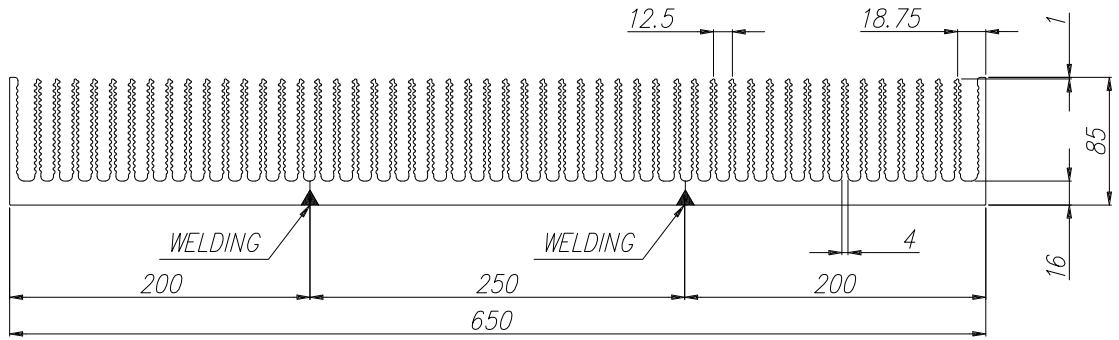

Up on request



KE700

Peso Kg/m  
Weight Kg/m

62.00

Rt °C/W --

Lung. campione mm  
Sample length mm 150

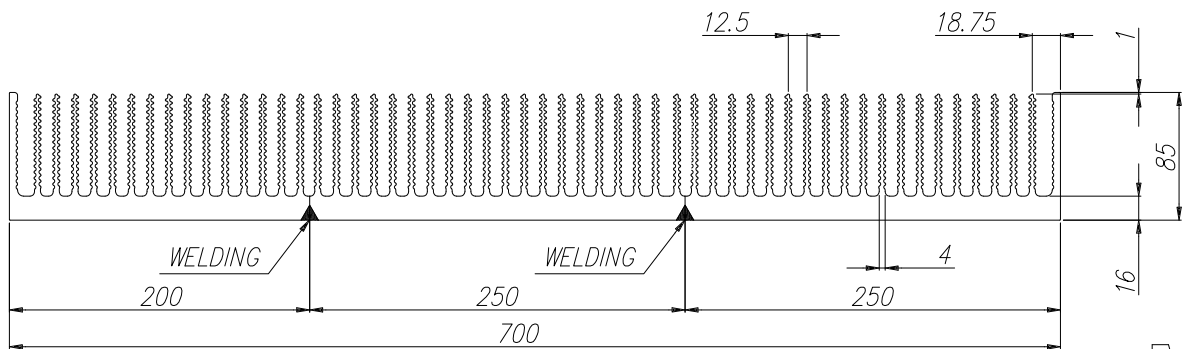

KE750

Peso Kg/m  
Weight Kg/m

66.38

Rt °C/W --

Lung. campione mm  
Sample length mm 150

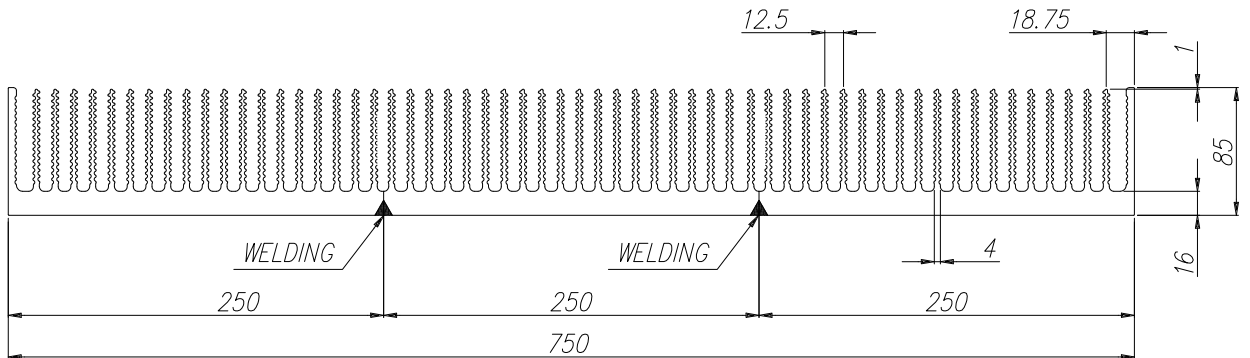

Up on request



KE800

Peso Kg/m  
Weight Kg/m

70.75

Rt °C/W --

Lung. campione mm  
Sample length mm 150

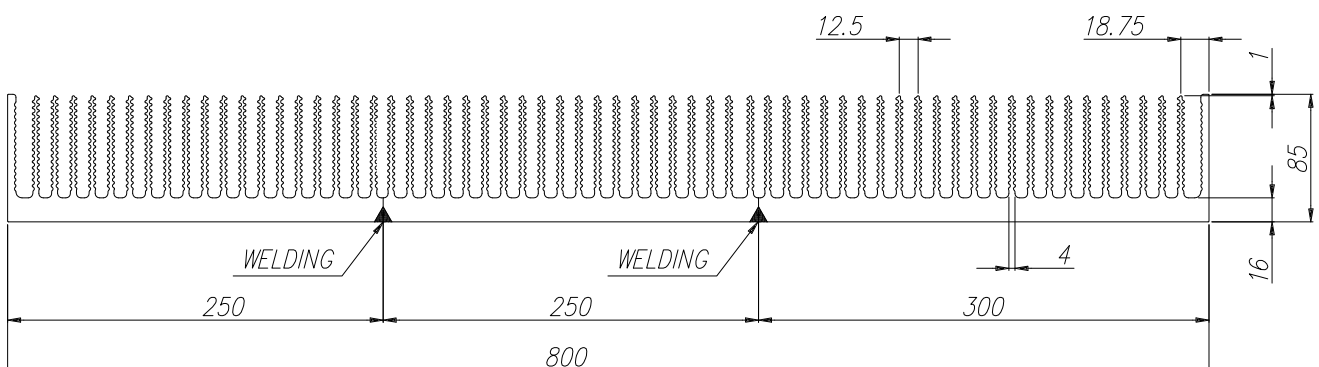

Up on request



KE850

Peso Kg/m  
Weight Kg/m

75.15

Rt °C/W --

Lung. campione mm  
Sample length mm

150

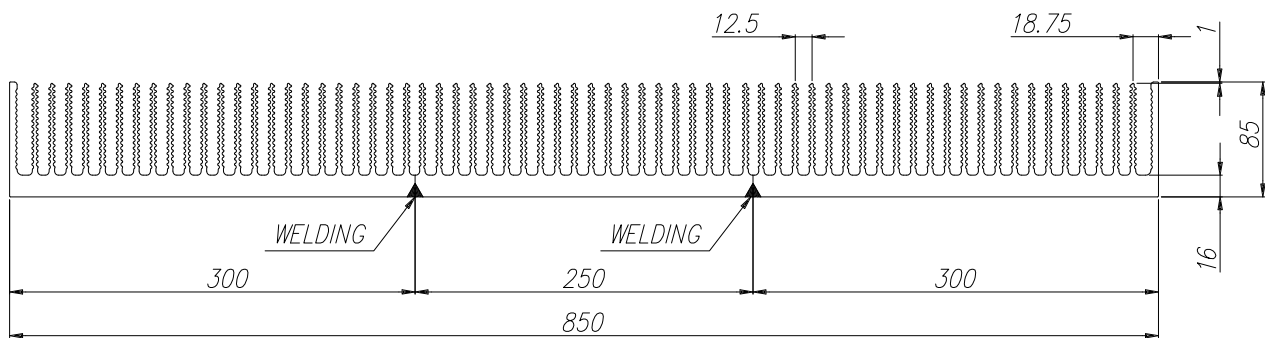

Up on request

TECNAL  
BOLOGNA - ITALY

WELDING K HEATSINKS SERIES - DISSIPATORI SALDATI SERIE K